



**PROJECT TITLE:**

**PROJECT NO:** 89313

**TEMPLE TERRACE\BY PASS CANAL LAND ACQUISITION (CIT II)**

**CIE REQUIREMENT:** Y

**LEVEL OF SERVICE IMPACT:** F

**PROGRAM:** PARKS

**Project Description:**

To acquire 95 acres of land on the Tampa By-Pass Canal to allow for expansion of the Temple Terrace Sports Complex.

**Neighborhood Community Area:**

Temple Terrace (City)

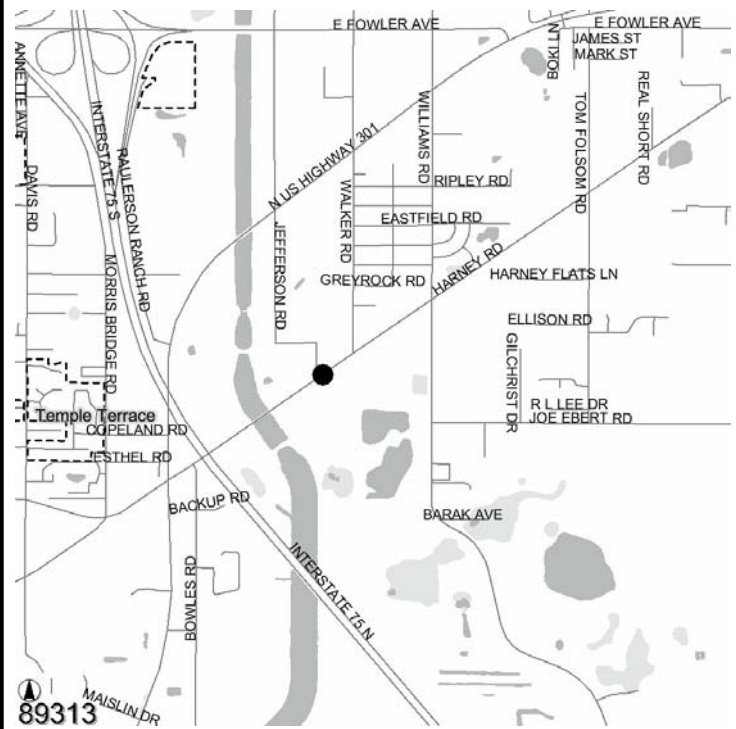

**Operating Cost Impact:**

None

**Project Completion Date:** Oct 2008

**Expenditure Plan (in \$000's):**

	<u>Total Est Cost</u>	<u>Prior Yrs Funding</u>	<u>FY 04</u>	<u>FY 05</u>	<u>FY 06</u>	<u>FY 07</u>	<u>FY 08</u>	<u>FY 09</u>	<u>Future</u>
Development	0	0	0	0	0	0	0	0	0
Design	0	0	0	0	0	0	0	0	0
Land/ROW	400	0	0	0	0	400	0	0	0
Construction	0	0	0	0	0	0	0	0	0
Equipment	0	0	0	0	0	0	0	0	0
Administration	0	0	0	0	0	0	0	0	0
<b>Total</b>	<b>\$400</b>	<b>\$0</b>	<b>\$0</b>	<b>\$0</b>	<b>\$0</b>	<b>\$400</b>	<b>\$0</b>	<b>\$0</b>	<b>\$0</b>

**Funding Sources (in \$000's):**

	<u>Total Est Cost</u>	<u>Prior Yrs Funding</u>	<u>FY 04</u>	<u>FY 05</u>	<u>FY 06</u>	<u>FY 07</u>	<u>FY 08</u>	<u>FY 09</u>	<u>Future</u>
Financing - CIT Backed	400	0	0	0	0	400	0	0	0
<b>Total</b>	<b>\$400</b>	<b>\$0</b>	<b>\$0</b>	<b>\$0</b>	<b>\$0</b>	<b>\$400</b>	<b>\$0</b>	<b>\$0</b>	<b>\$0</b>



**PROJECT TITLE:**

**PROJECT NO: 89314**

**TOWN N' COUNTRY/SHIMBERG SOCCER FIELD EXPANSION (CIT II)**

**CIE REQUIREMENT: Y**

**LEVEL OF SERVICE IMPACT: F**

**PROGRAM: PARKS**

**Project Description:**

Construct additional soccer fields at Shimberg Park in Town N' County.

**Neighborhood Community Area:**

Town N' Country (Northwest)

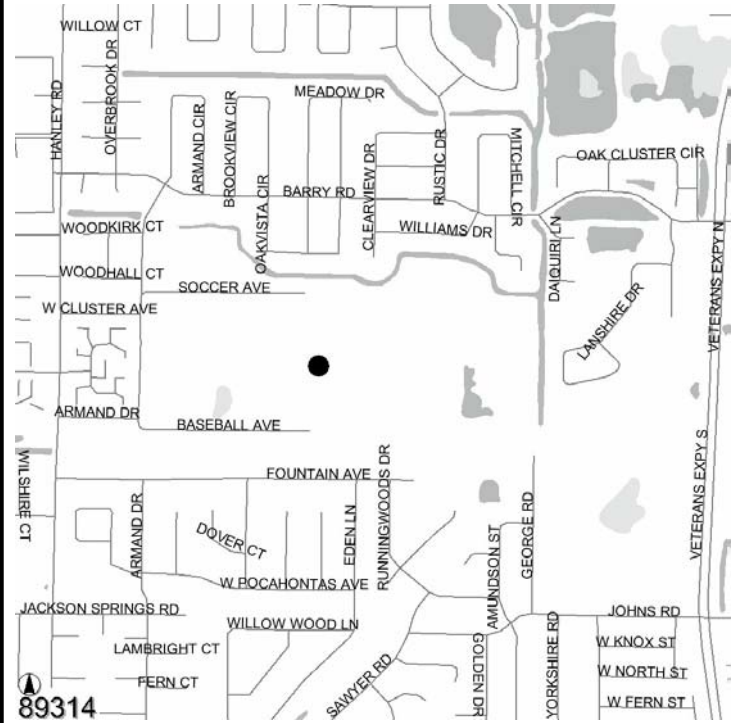

**Operating Cost Impact:**

Operating cost is estimated to be \$146,000 in FY 08 and \$148,000 thereafter.

**Project Completion Date: Oct 2007**

**Expenditure Plan (in \$000's):**

	<u>Total Est Cost</u>	<u>Prior Yrs Funding</u>	<u>FY 04</u>	<u>FY 05</u>	<u>FY 06</u>	<u>FY 07</u>	<u>FY 08</u>	<u>FY 09</u>	<u>Future</u>
Development	37	0	0	0	0	37	0	0	0
Design	0	0	0	0	0	0	0	0	0
Land/ROW	0	0	0	0	0	0	0	0	0
Construction	685	0	0	0	0	155	530	0	0
Equipment	0	0	0	0	0	0	0	0	0
Administration	28	0	0	0	0	8	20	0	0
<b>Total</b>	<b>\$750</b>	<b>\$0</b>	<b>\$0</b>	<b>\$0</b>	<b>\$0</b>	<b>\$200</b>	<b>\$550</b>	<b>\$0</b>	<b>\$0</b>

**Funding Sources (in \$000's):**

	<u>Total Est Cost</u>	<u>Prior Yrs Funding</u>	<u>FY 04</u>	<u>FY 05</u>	<u>FY 06</u>	<u>FY 07</u>	<u>FY 08</u>	<u>FY 09</u>	<u>Future</u>
Financing - CIT Backed	750	0	0	0	0	200	550	0	0
<b>Total</b>	<b>\$750</b>	<b>\$0</b>	<b>\$0</b>	<b>\$0</b>	<b>\$0</b>	<b>\$200</b>	<b>\$550</b>	<b>\$0</b>	<b>\$0</b>

