

PROJECT TITLE:
HILLSBOROUGH HEIGHTS LANDFILL COVER IMPROVEMENTS

PROJECT NO: 54031

CIE REQUIREMENT: Y

LEVEL OF SERVICE IMPACT: M

PROGRAM: SOLID WASTE

Project Description:

Design, permitting and construction of landfill cap improvements to improve stormwater drainage and reduce water infiltration.

Neighborhood Community Area:

Seffner (East)

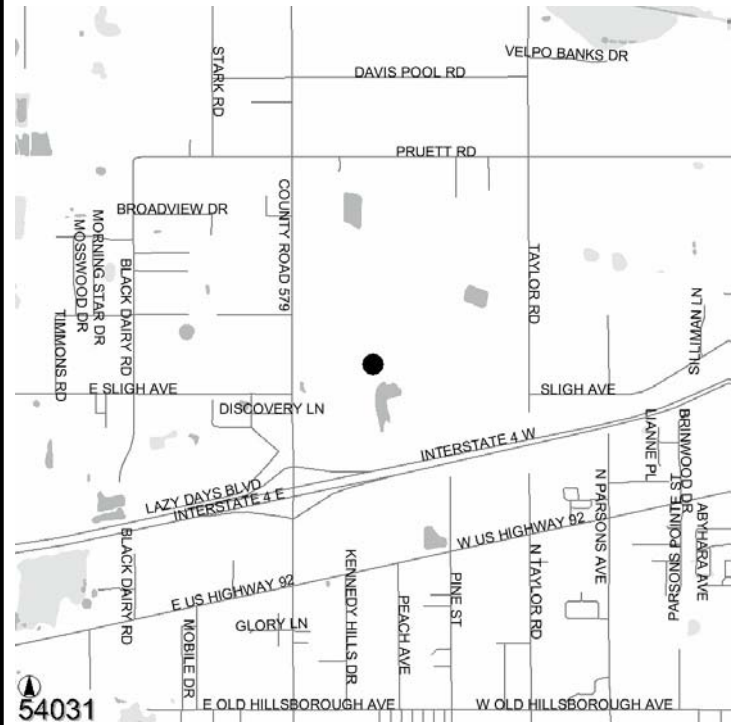

Operating Cost Impact:

None

Project Completion Date: Mar 2008

Expenditure Plan (in \$000's):

	<u>Total Est Cost</u>	<u>Prior Yrs Funding</u>	<u>FY 04</u>	<u>FY 05</u>	<u>FY 06</u>	<u>FY 07</u>	<u>FY 08</u>	<u>FY 09</u>	<u>Future</u>
Development	0	0	0	0	0	0	0	0	0
Design	50	0	0	0	50	0	0	0	0
Land/ROW	0	0	0	0	0	0	0	0	0
Construction	1,660	0	0	0	0	1,660	0	0	0
Equipment	0	0	0	0	0	0	0	0	0
Administration	0	0	0	0	0	0	0	0	0
Total	\$1,710	\$0	\$0	\$0	\$50	\$1,660	\$0	\$0	\$0

Funding Sources (in \$000's):

	<u>Total Est Cost</u>	<u>Prior Yrs Funding</u>	<u>FY 04</u>	<u>FY 05</u>	<u>FY 06</u>	<u>FY 07</u>	<u>FY 08</u>	<u>FY 09</u>	<u>Future</u>
Enterprise Fees	1,710	0	0	0	50	1,660	0	0	0
Total	\$1,710	\$0	\$0	\$0	\$50	\$1,660	\$0	\$0	\$0

PROJECT TITLE:**HILLSBOROUGH HEIGHTS LANDFILL GAS SYSTEM IMPROVEMENT****PROJECT NO: 54030****CIE REQUIREMENT: Y****LEVEL OF SERVICE IMPACT: M****PROGRAM: SOLID WASTE****Project Description:**

Design, permitting and construction of a replacement gas system for the Hillsborough Heights Landfill. Project to include a new headerline, wells, condensate collection system, and an improved blower station.

Neighborhood Community Area:

Seffner (East)

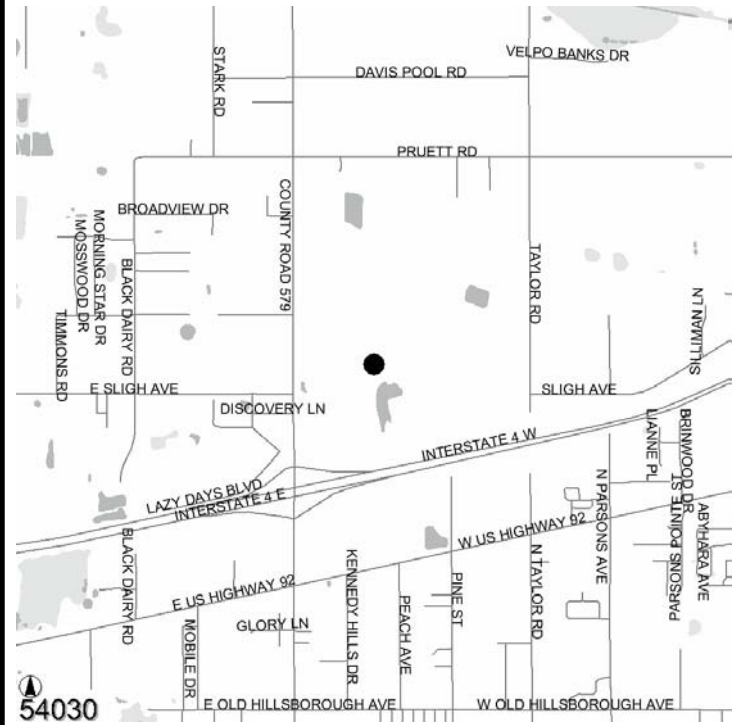
**Operating Cost Impact:**

None

Project Completion Date: Mar 2006**Expenditure Plan (in \$000's):**

	<u>Total Est Cost</u>	<u>Prior Yrs Funding</u>	<u>FY 04</u>	<u>FY 05</u>	<u>FY 06</u>	<u>FY 07</u>	<u>FY 08</u>	<u>FY 09</u>	<u>Future</u>
Development	0	0	0	0	0	0	0	0	0
Design	100	0	100	0	0	0	0	0	0
Land/ROW	0	0	0	0	0	0	0	0	0
Construction	1,240	0	0	1,240	0	0	0	0	0
Equipment	0	0	0	0	0	0	0	0	0
Administration	0	0	0	0	0	0	0	0	0
Total	\$1,340	\$0	\$100	\$1,240	\$0	\$0	\$0	\$0	\$0

Funding Sources (in \$000's):

	<u>Total Est Cost</u>	<u>Prior Yrs Funding</u>	<u>FY 04</u>	<u>FY 05</u>	<u>FY 06</u>	<u>FY 07</u>	<u>FY 08</u>	<u>FY 09</u>	<u>Future</u>
Enterprise Fees	1,340	0	100	1,240	0	0	0	0	0
Total	\$1,340	\$0	\$100	\$1,240	\$0	\$0	\$0	\$0	\$0

