

PROJECT TITLE:

PROJECT NO: 41069

CRAFT ROAD CULVERT REPLACEMENTS AND STORMWATER DETENTION FACILITY

CIE REQUIREMENT: Y

LEVEL OF SERVICE IMPACT: M

PROGRAM: STORMWATER

Project Description:

Replacement of the Craft Road, Church Road and Bryan Road culverts is recommended to achieve a full 25-year flooding level of service along this reach of the channel. In addition, a 3.4 acre stormwater detention pond located on vacant land east of the Southpointe subdivision is proposed to attenuate the downstream peak flows.

Neighborhood Community Area:

Brandon (Central)

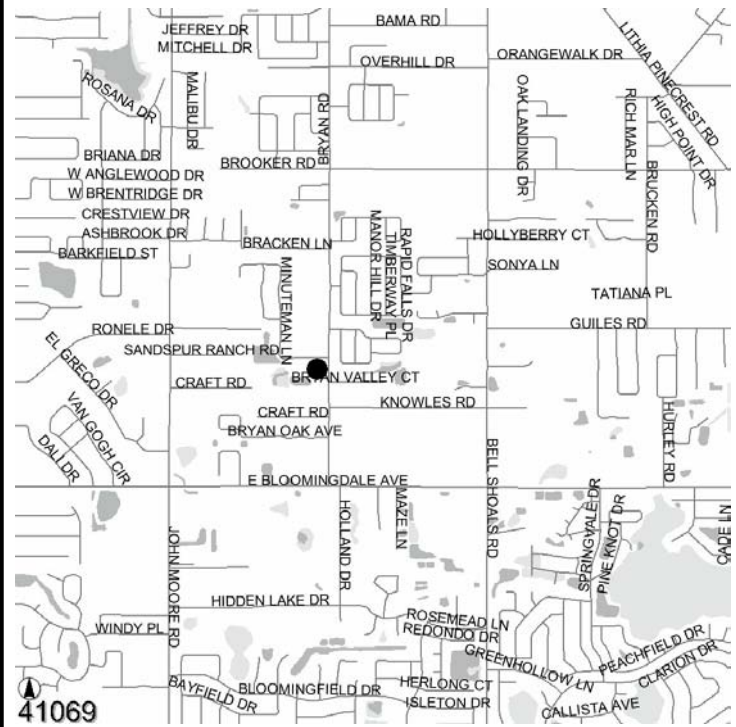

Operating Cost Impact:

Annual operating and maintenance costs are estimated to be \$3,745 per year.

Project Completion Date: Sep 2010

Expenditure Plan (in \$000's):

	<u>Total Est Cost</u>	<u>Prior Yrs Funding</u>	<u>FY 04</u>	<u>FY 05</u>	<u>FY 06</u>	<u>FY 07</u>	<u>FY 08</u>	<u>FY 09</u>	<u>Future</u>
Development	0	0	0	0	0	0	0	0	0
Design	60	0	60	0	0	0	0	0	0
Land/ROW	686	0	0	261	61	364	0	0	0
Construction	752	0	0	0	0	136	200	250	166
Equipment	0	0	0	0	0	0	0	0	0
Administration	0	0	0	0	0	0	0	0	0
Total	\$1,498	\$0	\$60	\$261	\$61	\$500	\$200	\$250	\$166

Funding Sources (in \$000's):

	<u>Total Est Cost</u>	<u>Prior Yrs Funding</u>	<u>FY 04</u>	<u>FY 05</u>	<u>FY 06</u>	<u>FY 07</u>	<u>FY 08</u>	<u>FY 09</u>	<u>Future</u>
Stormwater	1,498	0	60	261	61	500	200	250	166
Total	\$1,498	\$0	\$60	\$261	\$61	\$500	\$200	\$250	\$166

PROJECT TITLE:
CULVERT REPLACEMENT COUNTYWIDE FY 05

PROJECT NO: 47337

CIE REQUIREMENT: Y

LEVEL OF SERVICE IMPACT: M

PROGRAM: STORMWATER

Project Description:

Construct culvert replacements within different locations throughout the county.

Neighborhood Community Area:

Countywide



Operating Cost Impact:

Annual operating and maintenance costs are estimated to be \$1,875 per year.

Project Completion Date: Sep 2005

Expenditure Plan (in \$000's):

	<u>Total Est Cost</u>	<u>Prior Yrs Funding</u>	<u>FY 04</u>	<u>FY 05</u>	<u>FY 06</u>	<u>FY 07</u>	<u>FY 08</u>	<u>FY 09</u>	<u>Future</u>
Development	0	0	0	0	0	0	0	0	0
Design	0	0	0	0	0	0	0	0	0
Land/ROW	0	0	0	0	0	0	0	0	0
Construction	750	0	0	750	0	0	0	0	0
Equipment	0	0	0	0	0	0	0	0	0
Administration	0	0	0	0	0	0	0	0	0
Total	\$750	\$0	\$0	\$750	\$0	\$0	\$0	\$0	\$0

Funding Sources (in \$000's):

	<u>Total Est Cost</u>	<u>Prior Yrs Funding</u>	<u>FY 04</u>	<u>FY 05</u>	<u>FY 06</u>	<u>FY 07</u>	<u>FY 08</u>	<u>FY 09</u>	<u>Future</u>
Stormwater	750	0	0	750	0	0	0	0	0
Total	\$750	\$0	\$0	\$750	\$0	\$0	\$0	\$0	\$0