

PROJECT TITLE:
LAKE CEDAR WEST STORMWATER TREATMENT

PROJECT NO: 41074

CIE REQUIREMENT: Y
LEVEL OF SERVICE IMPACT: M

PROGRAM: STORMWATER

Project Description:

Curiosity Creek area - wet detention pond with vegetation.

Neighborhood Community Area:

Carrollwood (North Tampa)

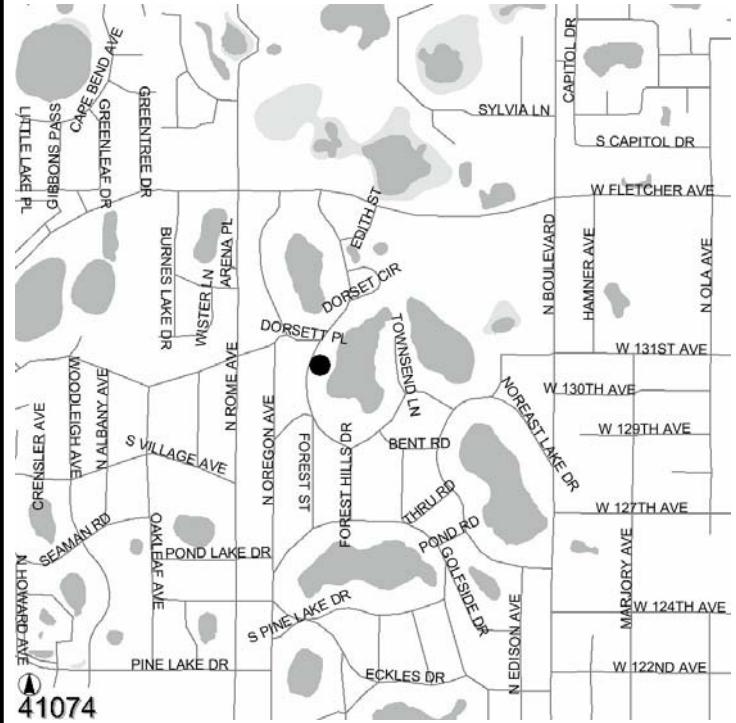

Operating Cost Impact:

Annual operating and maintenance costs are estimated to be \$523 per year.

Project Completion Date: Sep 2006

Expenditure Plan (in \$000's):

	<u>Total Est Cost</u>	<u>Prior Yrs Funding</u>	<u>FY 04</u>	<u>FY 05</u>	<u>FY 06</u>	<u>FY 07</u>	<u>FY 08</u>	<u>FY 09</u>	<u>Future</u>
Development	0	0	0	0	0	0	0	0	0
Design	60	0	0	60	0	0	0	0	0
Land/ROW	0	0	0	0	0	0	0	0	0
Construction	149	0	0	131	0	0	18	0	0
Equipment	0	0	0	0	0	0	0	0	0
Administration	0	0	0	0	0	0	0	0	0
Total	\$209	\$0	\$0	\$191	\$0	\$0	\$18	\$0	\$0

Funding Sources (in \$000's):

	<u>Total Est Cost</u>	<u>Prior Yrs Funding</u>	<u>FY 04</u>	<u>FY 05</u>	<u>FY 06</u>	<u>FY 07</u>	<u>FY 08</u>	<u>FY 09</u>	<u>Future</u>
Stormwater	209	0	0	191	0	0	18	0	0
Total	\$209	\$0	\$0	\$191	\$0	\$0	\$18	\$0	\$0

PROJECT TITLE:
LAKE FLYNN OUTLET

PROJECT NO: 41076

CIE REQUIREMENT: Y

LEVEL OF SERVICE IMPACT: M

PROGRAM: STORMWATER

Project Description:

Upgrade outfall and construct channel and/or upgrade pipes.

Neighborhood Community Area:

Lutz (North Tampa)



Operating Cost Impact:

Annual operating and maintenance costs are estimated to be \$290 per year.

Project Completion Date: Sep 2005

Expenditure Plan (in \$000's):

	<u>Total Est Cost</u>	<u>Prior Yrs Funding</u>	<u>FY 04</u>	<u>FY 05</u>	<u>FY 06</u>	<u>FY 07</u>	<u>FY 08</u>	<u>FY 09</u>	<u>Future</u>
Development	0	0	0	0	0	0	0	0	0
Design	60	0	60	0	0	0	0	0	0
Land/ROW	0	0	0	0	0	0	0	0	0
Construction	56	0	45	11	0	0	0	0	0
Equipment	0	0	0	0	0	0	0	0	0
Administration	0	0	0	0	0	0	0	0	0
Total	\$116	\$0	\$105	\$11	\$0	\$0	\$0	\$0	\$0

Funding Sources (in \$000's):

	<u>Total Est Cost</u>	<u>Prior Yrs Funding</u>	<u>FY 04</u>	<u>FY 05</u>	<u>FY 06</u>	<u>FY 07</u>	<u>FY 08</u>	<u>FY 09</u>	<u>Future</u>
Stormwater	116	0	105	11	0	0	0	0	0
Total	\$116	\$0	\$105	\$11	\$0	\$0	\$0	\$0	\$0

PROJECT TITLE:
LAKE FOREST OUTLET STRUCTURE

PROJECT NO: 41075

CIE REQUIREMENT: Y
LEVEL OF SERVICE IMPACT: M

PROGRAM: STORMWATER

Project Description:

Upgrade outfall and channel improvement.

Neighborhood Community Area:

New Tampa (North Tampa)

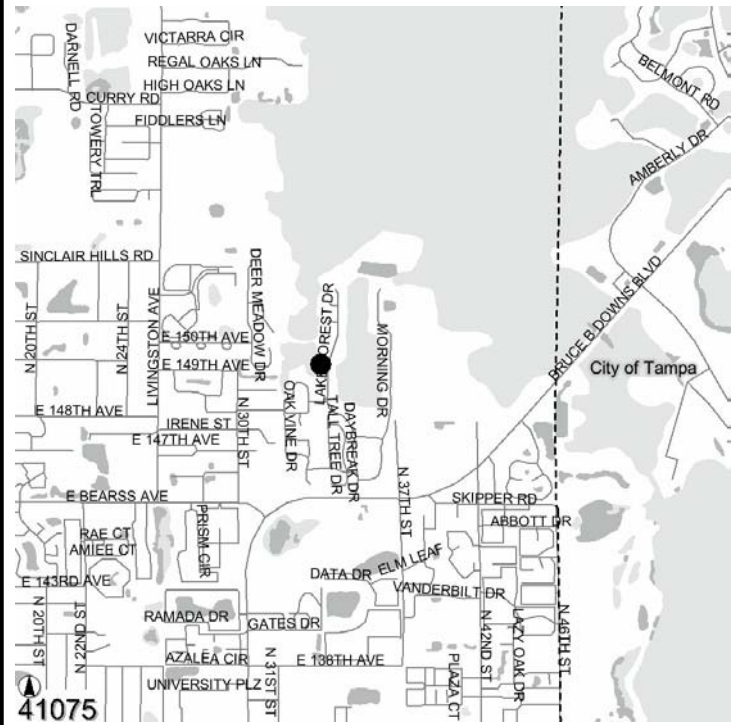

Operating Cost Impact:

Annual operating and maintenance costs are estimated to be \$173 per year.

Project Completion Date: Sep 2006

Expenditure Plan (in \$000's):

	<u>Total Est Cost</u>	<u>Prior Yrs Funding</u>	<u>FY 04</u>	<u>FY 05</u>	<u>FY 06</u>	<u>FY 07</u>	<u>FY 08</u>	<u>FY 09</u>	<u>Future</u>
Development	0	0	0	0	0	0	0	0	0
Design	39	0	0	39	0	0	0	0	0
Land/ROW	0	0	0	0	0	0	0	0	0
Construction	30	0	0	30	0	0	0	0	0
Equipment	0	0	0	0	0	0	0	0	0
Administration	0	0	0	0	0	0	0	0	0
Total	\$69	\$0	\$0	\$69	\$0	\$0	\$0	\$0	\$0

Funding Sources (in \$000's):

	<u>Total Est Cost</u>	<u>Prior Yrs Funding</u>	<u>FY 04</u>	<u>FY 05</u>	<u>FY 06</u>	<u>FY 07</u>	<u>FY 08</u>	<u>FY 09</u>	<u>Future</u>
Stormwater	69	0	0	69	0	0	0	0	0
Total	\$69	\$0	\$0	\$69	\$0	\$0	\$0	\$0	\$0

PROJECT TITLE:
LAKE GEORGE PUMP STATION
CIE REQUIREMENT: Y
LEVEL OF SERVICE IMPACT: M

PROJECT NO: 41064

PROGRAM: STORMWATER

Project Description:

Rebuild and replace old lift station.

Neighborhood Community Area:

Keystone (Northwest)

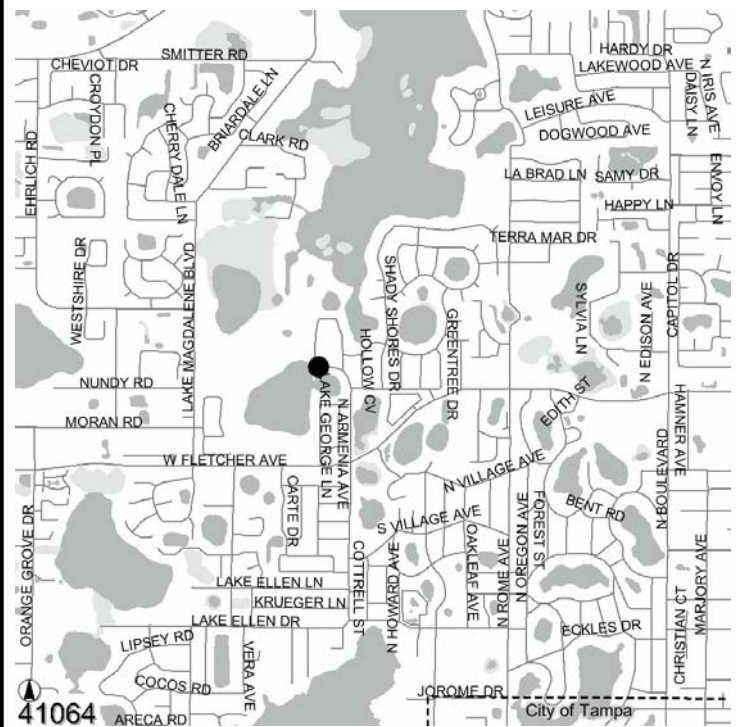

Operating Cost Impact:

Annual operating and maintenance costs are estimated to be \$475 per year.

Project Completion Date: Sep 2007

Expenditure Plan (in \$000's):

	<u>Total Est Cost</u>	<u>Prior Yrs Funding</u>	<u>FY 04</u>	<u>FY 05</u>	<u>FY 06</u>	<u>FY 07</u>	<u>FY 08</u>	<u>FY 09</u>	<u>Future</u>
Development	0	0	0	0	0	0	0	0	0
Design	39	0	0	39	0	0	0	0	0
Land/ROW	0	0	0	0	0	0	0	0	0
Construction	151	0	0	61	90	0	0	0	0
Equipment	0	0	0	0	0	0	0	0	0
Administration	0	0	0	0	0	0	0	0	0
Total	\$190	\$0	\$0	\$100	\$90	\$0	\$0	\$0	\$0

Funding Sources (in \$000's):

	<u>Total Est Cost</u>	<u>Prior Yrs Funding</u>	<u>FY 04</u>	<u>FY 05</u>	<u>FY 06</u>	<u>FY 07</u>	<u>FY 08</u>	<u>FY 09</u>	<u>Future</u>
Stormwater	190	0	0	100	90	0	0	0	0
Total	\$190	\$0	\$0	\$100	\$90	\$0	\$0	\$0	\$0