

CIE REQUIREMENT: Y

LEVEL OF SERVICE IMPACT: M

PROGRAM: STORMWATER

Project Description:

Implement recommendations identified in the consultant's report for critical locations within the Pemberton/Baker Creek area.

Neighborhood Community Area:

Seffner (East)

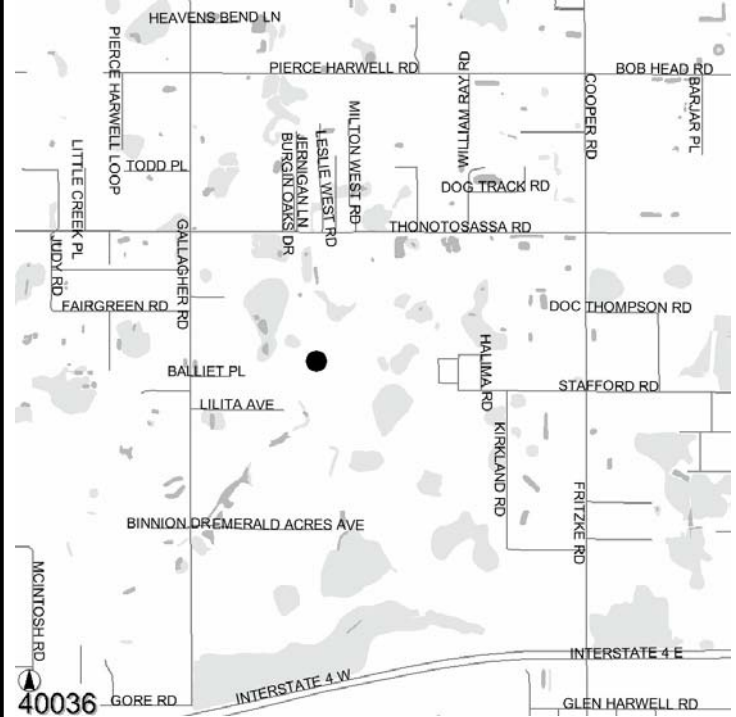

Operating Cost Impact:

Annual operating and maintenance costs are estimated to be \$300 per year.

Project Completion Date: Sep 2009

Expenditure Plan (in \$000's):

	<u>Total Est Cost</u>	<u>Prior Yrs Funding</u>	<u>FY 04</u>	<u>FY 05</u>	<u>FY 06</u>	<u>FY 07</u>	<u>FY 08</u>	<u>FY 09</u>	<u>Future</u>
Development	0	0	0	0	0	0	0	0	0
Design	125	0	0	0	50	0	50	25	0
Land/ROW	0	0	0	0	0	0	0	0	0
Construction	175	0	0	0	100	0	50	25	0
Equipment	0	0	0	0	0	0	0	0	0
Administration	0	0	0	0	0	0	0	0	0
Total	\$300	\$0	\$0	\$0	\$150	\$0	\$100	\$50	\$0

Funding Sources (in \$000's):

	<u>Total Est Cost</u>	<u>Prior Yrs Funding</u>	<u>FY 04</u>	<u>FY 05</u>	<u>FY 06</u>	<u>FY 07</u>	<u>FY 08</u>	<u>FY 09</u>	<u>Future</u>
Stormwater	300	0	0	0	150	0	100	50	0
Total	\$300	\$0	\$0	\$0	\$150	\$0	\$100	\$50	\$0

Project Description:

Begin design and right of way acquisition to implement consultant recommendations for stormwater improvements within the Silver/ Twin Lake watershed.

Neighborhood Community Area:

Town N' Country (Northwest)



Operating Cost Impact:

Annual operating and maintenance costs are estimated to be \$1,125 per year.

Project Completion Date: Sep 2009

Expenditure Plan (in \$000's):

	<u>Total Est Cost</u>	<u>Prior Yrs Funding</u>	<u>FY 04</u>	<u>FY 05</u>	<u>FY 06</u>	<u>FY 07</u>	<u>FY 08</u>	<u>FY 09</u>	<u>Future</u>
Development	0	0	0	0	0	0	0	0	0
Design	11	0	11	0	0	0	0	0	0
Land/ROW	0	0	0	0	0	0	0	0	0
Construction	500	0	0	200	0	0	150	150	0
Equipment	0	0	0	0	0	0	0	0	0
Administration	0	0	0	0	0	0	0	0	0
Total	\$511	\$0	\$11	\$200	\$0	\$0	\$150	\$150	\$0

Funding Sources (in \$000's):

	<u>Total Est Cost</u>	<u>Prior Yrs Funding</u>	<u>FY 04</u>	<u>FY 05</u>	<u>FY 06</u>	<u>FY 07</u>	<u>FY 08</u>	<u>FY 09</u>	<u>Future</u>
Stormwater	511	0	11	200	0	0	150	150	0
Total	\$511	\$0	\$11	\$200	\$0	\$0	\$150	\$150	\$0

PROJECT TITLE:

PROJECT NO: 47344

SLIGH AVENUE STORMWATER IMPROVEMENTS PHASE III

CIE REQUIREMENT: Y

LEVEL OF SERVICE IMPACT: E

PROGRAM: STORMWATER

Project Description:

Design and construct improvements to alleviate flooding along Minnehaha Street and Arlene Street.

Neighborhood Community Area:

Town N' Country (Northwest)

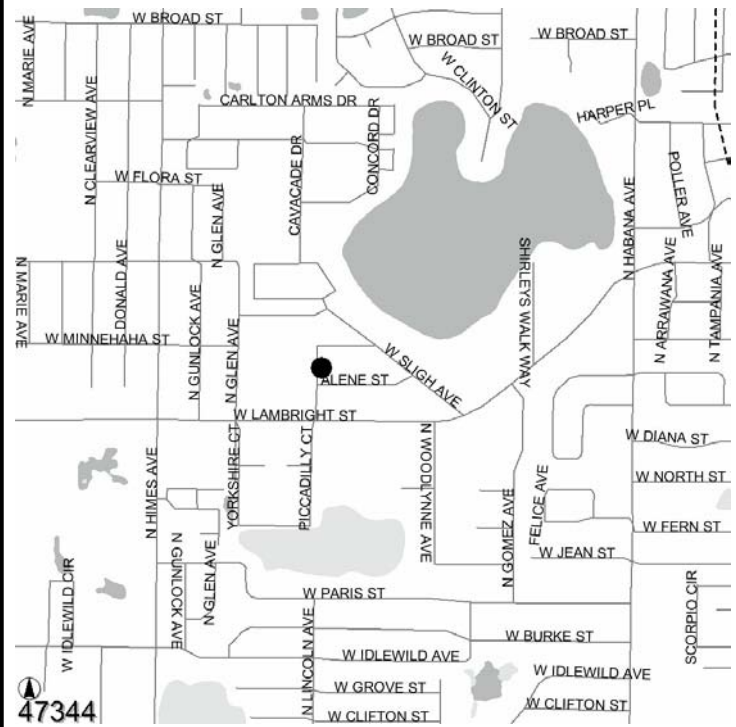

Operating Cost Impact:

Annual operating and maintenance costs are estimated to be \$880 per year.

Project Completion Date: Sep 2006

Expenditure Plan (in \$000's):

	<u>Total Est Cost</u>	<u>Prior Yrs Funding</u>	<u>FY 04</u>	<u>FY 05</u>	<u>FY 06</u>	<u>FY 07</u>	<u>FY 08</u>	<u>FY 09</u>	<u>Future</u>
Development	0	0	0	0	0	0	0	0	0
Design	25	0	25	0	0	0	0	0	0
Land/ROW	10	0	10	0	0	0	0	0	0
Construction	410	0	0	0	410	0	0	0	0
Equipment	0	0	0	0	0	0	0	0	0
Administration	0	0	0	0	0	0	0	0	0
Total	\$445	\$0	\$35	\$0	\$410	\$0	\$0	\$0	\$0

Funding Sources (in \$000's):

	<u>Total Est Cost</u>	<u>Prior Yrs Funding</u>	<u>FY 04</u>	<u>FY 05</u>	<u>FY 06</u>	<u>FY 07</u>	<u>FY 08</u>	<u>FY 09</u>	<u>Future</u>
Stormwater	445	0	35	0	410	0	0	0	0
Total	\$445	\$0	\$35	\$0	\$410	\$0	\$0	\$0	\$0