

**PROJECT TITLE:**

FAWN RIDGE CHLORINE GENERATION SYSTEM

PROJECT NO: 31940

CIE REQUIREMENT: Y

LEVEL OF SERVICE IMPACT: E

PROGRAM: UTILITIES/WATER

**Project Description:**

Design, permit and construct an on-site chlorine generation system at the Fawn Ridge Water Plant that produces a very low strength hypochlorite solution.

**Neighborhood Community Area:**

Citrus Park (Northwest)

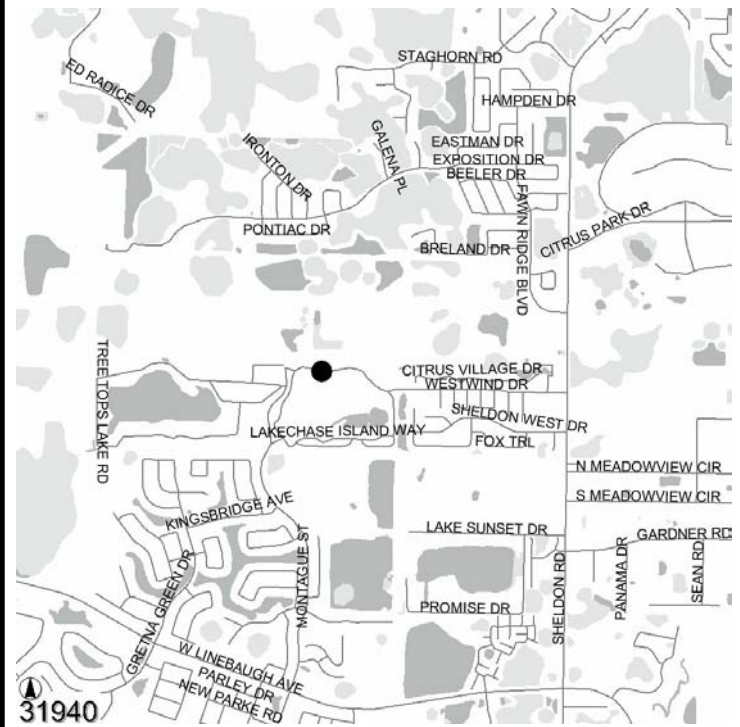
**Operating Cost Impact:**

Operating cost impact of \$100,000 per year starting in FY 08.

**Project Completion Date:** Sep 2007**Expenditure Plan (in \$000's):**

	<u>Total Est Cost</u>	<u>Prior Yrs Funding</u>	<u>FY 04</u>	<u>FY 05</u>	<u>FY 06</u>	<u>FY 07</u>	<u>FY 08</u>	<u>FY 09</u>	<u>Future</u>
Development	161	0	48	113	0	0	0	0	0
Design	227	0	0	227	0	0	0	0	0
Land/ROW	0	0	0	0	0	0	0	0	0
Construction	1,216	0	0	0	1,216	0	0	0	0
Equipment	0	0	0	0	0	0	0	0	0
Administration	16	0	16	0	0	0	0	0	0
<b>Total</b>	<b>\$1,620</b>	<b>\$0</b>	<b>\$64</b>	<b>\$340</b>	<b>\$1,216</b>	<b>\$0</b>	<b>\$0</b>	<b>\$0</b>	<b>\$0</b>

**Funding Sources (in \$000's):**

	<u>Total Est Cost</u>	<u>Prior Yrs Funding</u>	<u>FY 04</u>	<u>FY 05</u>	<u>FY 06</u>	<u>FY 07</u>	<u>FY 08</u>	<u>FY 09</u>	<u>Future</u>
Enterprise Fees	1,620	0	64	340	1,216	0	0	0	0
<b>Total</b>	<b>\$1,620</b>	<b>\$0</b>	<b>\$64</b>	<b>\$340</b>	<b>\$1,216</b>	<b>\$0</b>	<b>\$0</b>	<b>\$0</b>	<b>\$0</b>

**PROJECT TITLE:****PROJECT NO: 31935****FAWN RIDGE WATER PLANT BUILDING IMPROVEMENT****CIE REQUIREMENT: Y****LEVEL OF SERVICE IMPACT: M****PROGRAM: UTILITIES/WATER****Project Description:**

The Fawn Ridge Water Plant building is deteriorating and needs renewal and replacement of certain components including a new sloped roof, air conditioning system, wall modifications for hurricane loads as well as and interior finishes.

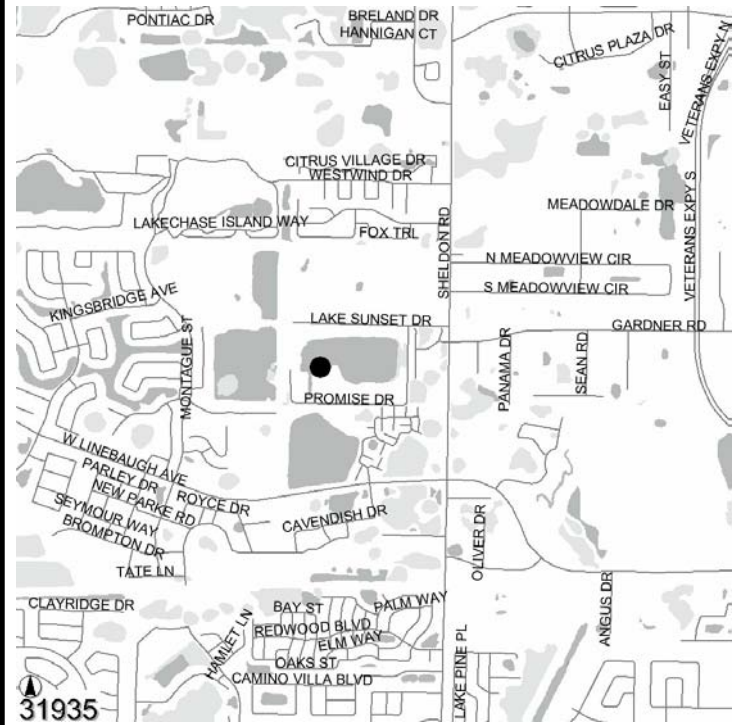
**Neighborhood Community Area:****Carrollwood (North Tampa)****Operating Cost Impact:**

None

**Project Completion Date: Jan 2008****Expenditure Plan (in \$000's):**

	<u>Total Est Cost</u>	<u>Prior Yrs Funding</u>	<u>FY 04</u>	<u>FY 05</u>	<u>FY 06</u>	<u>FY 07</u>	<u>FY 08</u>	<u>FY 09</u>	<u>Future</u>
Development	176	0	0	176	0	0	0	0	0
Design	224	0	0	0	224	0	0	0	0
Land/ROW	0	0	0	0	0	0	0	0	0
Construction	1,030	0	0	0	1,030	0	0	0	0
Equipment	0	0	0	0	0	0	0	0	0
Administration	170	0	0	0	170	0	0	0	0
<b>Total</b>	<b>\$1,600</b>	<b>\$0</b>	<b>\$0</b>	<b>\$176</b>	<b>\$1,424</b>	<b>\$0</b>	<b>\$0</b>	<b>\$0</b>	<b>\$0</b>

**Funding Sources (in \$000's):**

	<u>Total Est Cost</u>	<u>Prior Yrs Funding</u>	<u>FY 04</u>	<u>FY 05</u>	<u>FY 06</u>	<u>FY 07</u>	<u>FY 08</u>	<u>FY 09</u>	<u>Future</u>
Enterprise Fees	1,600	0	0	176	1,424	0	0	0	0
<b>Total</b>	<b>\$1,600</b>	<b>\$0</b>	<b>\$0</b>	<b>\$176</b>	<b>\$1,424</b>	<b>\$0</b>	<b>\$0</b>	<b>\$0</b>	<b>\$0</b>

**PROJECT TITLE:**

**PROJECT NO: 31943**

**FAWN RIDGE/LAKE PARK VARIABLE FREQUENCY DRIVE REPLACEMENT**

**CIE REQUIREMENT: Y**

**LEVEL OF SERVICE IMPACT: M**

**PROGRAM: UTILITIES/WATER**

**Project Description:**

Design and construct replacement VFD controls for out of production existing controls. Replace existing constant speed controllers with VFD controllers. Install system controllers to link the two Water Treatment plants and provide better flow and pressure control within the distribution system.

**Neighborhood Community Area:**

Countywide

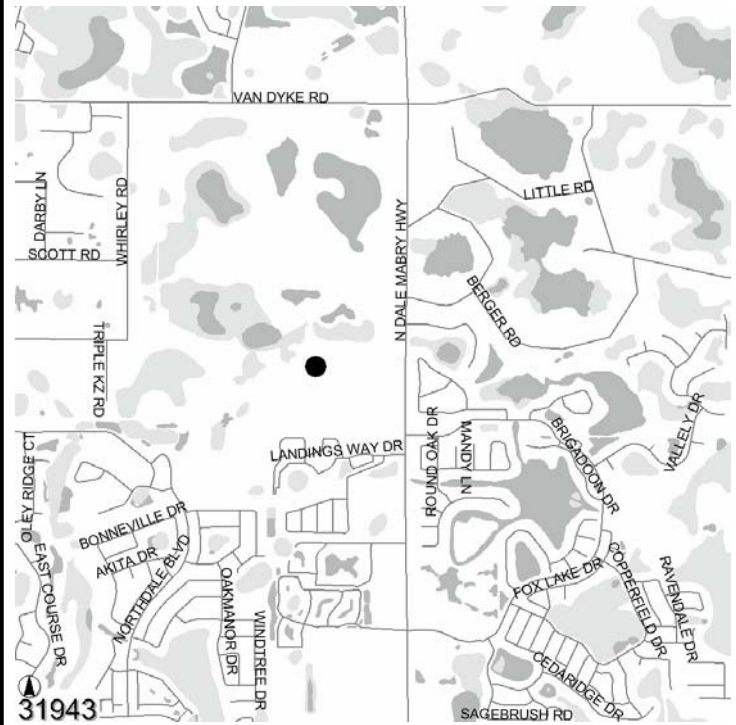

**Operating Cost Impact:**

None

**Project Completion Date: Aug 2006**

**Expenditure Plan (in \$000's):**

	<u>Total Est Cost</u>	<u>Prior Yrs Funding</u>	<u>FY 04</u>	<u>FY 05</u>	<u>FY 06</u>	<u>FY 07</u>	<u>FY 08</u>	<u>FY 09</u>	<u>Future</u>
Development	131	0	131	0	0	0	0	0	0
Design	183	0	183	0	0	0	0	0	0
Land/ROW	0	0	0	0	0	0	0	0	0
Construction	982	0	0	982	0	0	0	0	0
Equipment	0	0	0	0	0	0	0	0	0
Administration	14	0	14	0	0	0	0	0	0
<b>Total</b>	<b>\$1,310</b>	<b>\$0</b>	<b>\$328</b>	<b>\$982</b>	<b>\$0</b>	<b>\$0</b>	<b>\$0</b>	<b>\$0</b>	<b>\$0</b>

**Funding Sources (in \$000's):**

	<u>Total Est Cost</u>	<u>Prior Yrs Funding</u>	<u>FY 04</u>	<u>FY 05</u>	<u>FY 06</u>	<u>FY 07</u>	<u>FY 08</u>	<u>FY 09</u>	<u>Future</u>
Enterprise Fees	1,310	0	328	982	0	0	0	0	0
<b>Total</b>	<b>\$1,310</b>	<b>\$0</b>	<b>\$328</b>	<b>\$982</b>	<b>\$0</b>	<b>\$0</b>	<b>\$0</b>	<b>\$0</b>	<b>\$0</b>

**PROJECT TITLE:**

**PROJECT NO: 39158**

**FUTURE ACQUISITION OF WATER/WASTEWATER UTILITY SYSTEMS**

**CIE REQUIREMENT: Y**

**LEVEL OF SERVICE IMPACT: F**

**PROGRAM: UTILITIES/WATER**

**Project Description:**

This account has been established to reserve funds for the acquisition of future water/wastewater franchises. As franchises are approved for purchase, funds will be transferred to create a project under the franchise name.

**Neighborhood Community Area:**

Countywide



**Operating Cost Impact:**

Not Applicable

**Project Completion Date: N/A**

**Expenditure Plan (in \$000's):**

	<u>Total Est Cost</u>	<u>Prior Yrs Funding</u>	<u>FY 04</u>	<u>FY 05</u>	<u>FY 06</u>	<u>FY 07</u>	<u>FY 08</u>	<u>FY 09</u>	<u>Future</u>
Development	0	0	0	0	0	0	0	0	0
Design	0	0	0	0	0	0	0	0	0
Land/ROW	0	0	0	0	0	0	0	0	0
Construction	9,827	4,718	509	1,000	1,000	2,100	500	0	0
Equipment	0	0	0	0	0	0	0	0	0
Administration	0	0	0	0	0	0	0	0	0
<b>Total</b>	<b>\$9,827</b>	<b>\$4,718</b>	<b>\$509</b>	<b>\$1,000</b>	<b>\$1,000</b>	<b>\$2,100</b>	<b>\$500</b>	<b>\$0</b>	<b>\$0</b>

**Funding Sources (in \$000's):**

	<u>Total Est Cost</u>	<u>Prior Yrs Funding</u>	<u>FY 04</u>	<u>FY 05</u>	<u>FY 06</u>	<u>FY 07</u>	<u>FY 08</u>	<u>FY 09</u>	<u>Future</u>
Community Invest. Tax I	4,718	4,718	0	0	0	0	0	0	0
Financing - CIT Backed	5,109	0	509	1,000	1,000	2,100	500	0	0
<b>Total</b>	<b>\$9,827</b>	<b>\$4,718</b>	<b>\$509</b>	<b>\$1,000</b>	<b>\$1,000</b>	<b>\$2,100</b>	<b>\$500</b>	<b>\$0</b>	<b>\$0</b>

**Note: Financing supported by CIT II proceeds.**

