

**PROJECT TITLE:**

**PROJECT NO:** 89316

**PLANT CITY ELLIS METHVIN PARK PHASE I**

**CIE REQUIREMENT:** Y

**LEVEL OF SERVICE IMPACT:** E

**PROGRAM:** PARKS

**Project Description:**

Provide funding assistance to the City of Plant City for the first phase construction of a sports complex at Ellis Methvin Park located in Plant City. Funding level in FY 05 is contingent upon following: Project is to be funded at a level not to exceed standard County park amenities and at price level not to exceed the County available contracts, that the City be required to submit to the Hillsborough County Parks Department a detailed budget for the first phase, and that a written agreement be reached between the two parties regarding the Hillsborough County subsequent oversight responsibilities.

**Neighborhood Community Area:**

Plant City

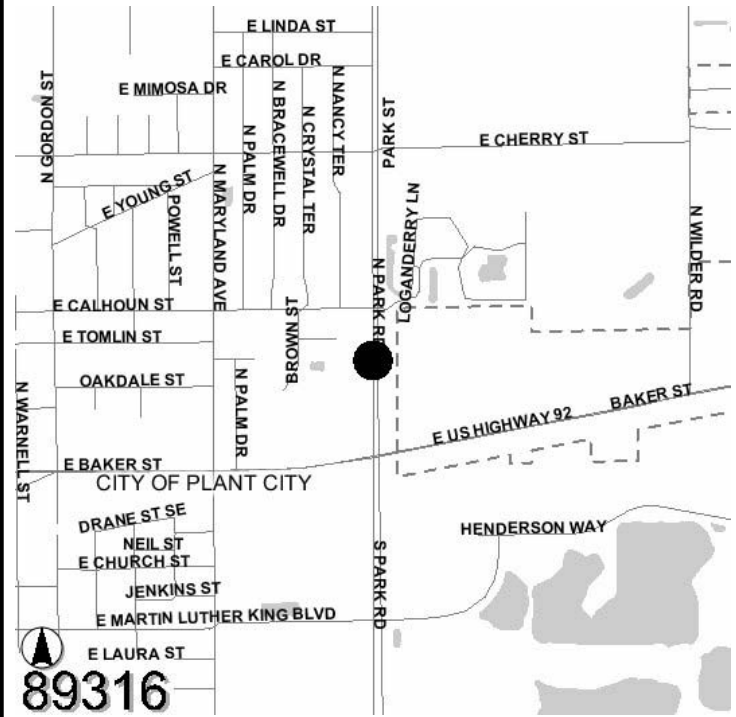

**Operating Cost Impact:**

None

**Project Completion Date:** May 2005

**Expenditure Plan (in \$000's):**

	<u>Total Est Cost</u>	<u>Prior Yrs Funding</u>	<u>FY 05</u>	<u>FY 06</u>	<u>FY 07</u>	<u>FY 08</u>	<u>FY 09</u>	<u>Future</u>
Development	0	0	0	0	0	0	0	0
Design	0	0	0	0	0	0	0	0
Land/ROW	0	0	0	0	0	0	0	0
Construction	0	0	0	0	0	0	0	0
Equipment	0	0	0	0	0	0	0	0
Administration	700	350	350	0	0	0	0	0
<b>Total</b>	<b>\$700</b>	<b>\$350</b>	<b>\$350</b>	<b>\$0</b>	<b>\$0</b>	<b>\$0</b>	<b>\$0</b>	<b>\$0</b>

**Funding Sources (in \$000's):**

	<u>Total Est Cost</u>	<u>Prior Yrs Funding</u>	<u>FY 05</u>	<u>FY 06</u>	<u>FY 07</u>	<u>FY 08</u>	<u>FY 09</u>	<u>Future</u>
General Revenues	700	350	350	0	0	0	0	0
<b>Total</b>	<b>\$700</b>	<b>\$350</b>	<b>\$350</b>	<b>\$0</b>	<b>\$0</b>	<b>\$0</b>	<b>\$0</b>	<b>\$0</b>

**Project Description:**

Acquire 117 acres of land adjacent to the park for future park development. Progress Village Park is very tight for space and is not laid out efficiently. The acquisition of land from the Water Department will allow for better utilization of the park site and provide a link to Clair Mel Elementary School.

**Neighborhood Community Area:**

Palm River (Central)

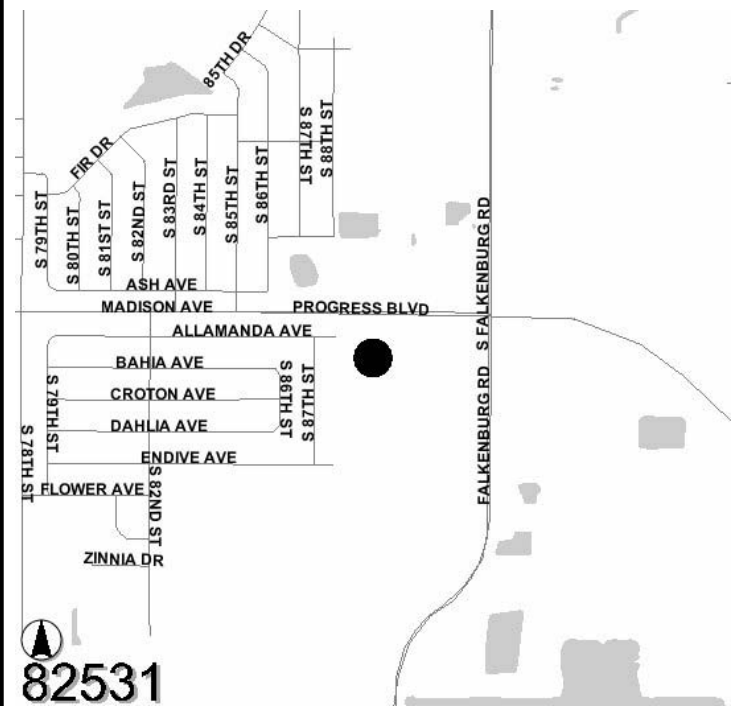

**Operating Cost Impact:**

Annual operating cost of \$40,000 beginning in FY06.

**Project Completion Date: Dec 2004**

**Expenditure Plan (in \$000's):**

	<u>Total Est Cost</u>	<u>Prior Yrs Funding</u>	<u>FY 05</u>	<u>FY 06</u>	<u>FY 07</u>	<u>FY 08</u>	<u>FY 09</u>	<u>Future</u>
Development	0	0	0	0	0	0	0	0
Design	0	0	0	0	0	0	0	0
Land/ROW	2,208	200	2,008	0	0	0	0	0
Construction	0	0	0	0	0	0	0	0
Equipment	0	0	0	0	0	0	0	0
Administration	8	8	0	0	0	0	0	0
<b>Total</b>	<b>\$2,216</b>	<b>\$208</b>	<b>\$2,008</b>	<b>\$0</b>	<b>\$0</b>	<b>\$0</b>	<b>\$0</b>	<b>\$0</b>

**Funding Sources (in \$000's):**

	<u>Total Est Cost</u>	<u>Prior Yrs Funding</u>	<u>FY 05</u>	<u>FY 06</u>	<u>FY 07</u>	<u>FY 08</u>	<u>FY 09</u>	<u>Future</u>
Grants & County Match	416	208	208	0	0	0	0	0
Impact Fees	1,800	0	1,800	0	0	0	0	0
<b>Total</b>	<b>\$2,216</b>	<b>\$208</b>	<b>\$2,008</b>	<b>\$0</b>	<b>\$0</b>	<b>\$0</b>	<b>\$0</b>	<b>\$0</b>



**PROJECT TITLE:**  
**RUSKIN COMMONGOOD BOAT RAMP CONSTRUCTION**

**PROJECT NO:** 83213

**CIE REQUIREMENT:** Y

**LEVEL OF SERVICE IMPACT:** M

**PROGRAM:** PARKS

**Project Description:**

Improve and upgrade the Boat Ramp. Improvements will include: additional paved parking, resurfacing of the existing entry road, additional picnic shelters, erosion control, upgrade dock, and additional sidewalks and shaded trees.

**Neighborhood Community Area:**

Ruskin (South)

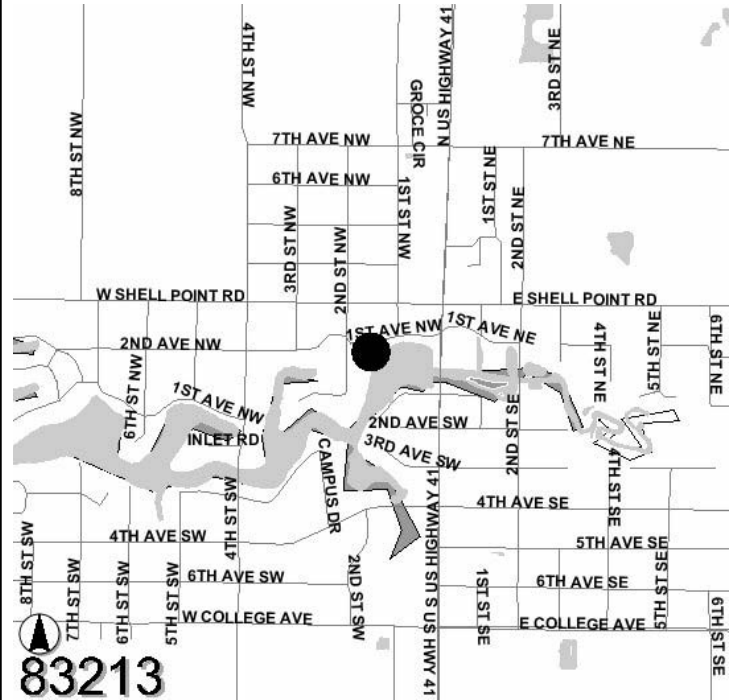

**Operating Cost Impact:**

None

**Project Completion Date:** Oct 2008

**Expenditure Plan (in \$000's):**

	<u>Total Est Cost</u>	<u>Prior Yrs Funding</u>	<u>FY 05</u>	<u>FY 06</u>	<u>FY 07</u>	<u>FY 08</u>	<u>FY 09</u>	<u>Future</u>
Development	0	0	0	0	0	0	0	0
Design	0	0	0	0	0	0	0	0
Land/ROW	0	0	0	0	0	0	0	0
Construction	25	0	25	0	0	0	0	0
Equipment	0	0	0	0	0	0	0	0
Administration	0	0	0	0	0	0	0	0
<b>Total</b>	<b>\$25</b>	<b>\$0</b>	<b>\$25</b>	<b>\$0</b>	<b>\$0</b>	<b>\$0</b>	<b>\$0</b>	<b>\$0</b>

**Funding Sources (in \$000's):**

	<u>Total Est Cost</u>	<u>Prior Yrs Funding</u>	<u>FY 05</u>	<u>FY 06</u>	<u>FY 07</u>	<u>FY 08</u>	<u>FY 09</u>	<u>Future</u>
Boat Fees	25	0	25	0	0	0	0	0
<b>Total</b>	<b>\$25</b>	<b>\$0</b>	<b>\$25</b>	<b>\$0</b>	<b>\$0</b>	<b>\$0</b>	<b>\$0</b>	<b>\$0</b>

