





**Project Description:**

Implement recommendations contained in the report to improve the conveyance ability of the overall drainage system at those locations identified in the Brooker Creek Master Plan.

**Neighborhood Community Area:**

Keystone (Northwest)



**Operating Cost Impact:**

Annual operating and maintenance costs are estimated to be \$100 per year.

**Project Completion Date:** Aug 2012

**Expenditure Plan (in \$000's):**

	<u>Total Est Cost</u>	<u>Prior Yrs Funding</u>	<u>FY 05</u>	<u>FY 06</u>	<u>FY 07</u>	<u>FY 08</u>	<u>FY 09</u>	<u>Future</u>
Development	0	0	0	0	0	0	0	0
Design	111	0	11	0	0	50	50	0
Land/ROW	0	0	0	0	0	0	0	0
Construction	41	0	0	41	0	0	0	0
Equipment	0	0	0	0	0	0	0	0
Administration	0	0	0	0	0	0	0	0
<b>Total</b>	<b>\$152</b>	<b>\$0</b>	<b>\$11</b>	<b>\$41</b>	<b>\$0</b>	<b>\$50</b>	<b>\$50</b>	<b>\$0</b>

**Funding Sources (in \$000's):**

	<u>Total Est Cost</u>	<u>Prior Yrs Funding</u>	<u>FY 05</u>	<u>FY 06</u>	<u>FY 07</u>	<u>FY 08</u>	<u>FY 09</u>	<u>Future</u>
Stormwater	152	0	11	41	0	50	50	0
<b>Total</b>	<b>\$152</b>	<b>\$0</b>	<b>\$11</b>	<b>\$41</b>	<b>\$0</b>	<b>\$50</b>	<b>\$50</b>	<b>\$0</b>

**CIE REQUIREMENT: Y**

**LEVEL OF SERVICE IMPACT: E**

**PROGRAM: STORMWATER**

**Project Description:**

Begin design and right-of-way acquisition to implement consultant recommendations for stormwater improvements within the Bullfrog Creek watershed.

**Neighborhood Community Area:**

Various



**Operating Cost Impact:**

Annual operating and maintenance costs are estimated to be \$2,000 per year.

**Project Completion Date: Aug 2012**

**Expenditure Plan (in \$000's):**

	<u>Total Est Cost</u>	<u>Prior Yrs Funding</u>	<u>FY 05</u>	<u>FY 06</u>	<u>FY 07</u>	<u>FY 08</u>	<u>FY 09</u>	<u>Future</u>
Development	0	0	0	0	0	0	0	0
Design	0	0	0	0	0	0	0	0
Land/ROW	0	0	0	0	0	0	0	0
Construction	258	0	0	0	0	158	100	0
Equipment	0	0	0	0	0	0	0	0
Administration	0	0	0	0	0	0	0	0
<b>Total</b>	<b>\$258</b>	<b>\$0</b>	<b>\$0</b>	<b>\$0</b>	<b>\$0</b>	<b>\$158</b>	<b>\$100</b>	<b>\$0</b>

**Funding Sources (in \$000's):**

	<u>Total Est Cost</u>	<u>Prior Yrs Funding</u>	<u>FY 05</u>	<u>FY 06</u>	<u>FY 07</u>	<u>FY 08</u>	<u>FY 09</u>	<u>Future</u>
Stormwater	258	0	0	0	0	158	100	0
<b>Total</b>	<b>\$258</b>	<b>\$0</b>	<b>\$0</b>	<b>\$0</b>	<b>\$0</b>	<b>\$158</b>	<b>\$100</b>	<b>\$0</b>

**PROJECT TITLE:**

**PROJECT NO: 41061**

**BUTTON WOOD PUMP STATION PROJECT**

**CIE REQUIREMENT: N**

**LEVEL OF SERVICE IMPACT:**

**PROGRAM: STORMWATER**

**Project Description:**

Existing pump station is located on private property. Option one is to purchase the lot where the pump is currently located; option two is to relocate the pump to the existing right of way if possible; option three is to check on gravity outfall by the construction ditch system to the west.

**Neighborhood Community Area:**

Bloomington (Central)

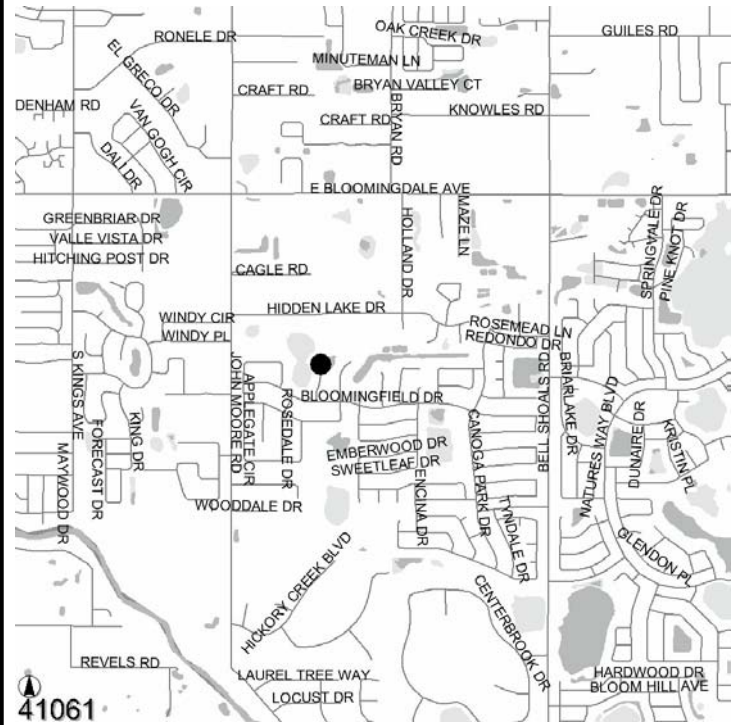

**Operating Cost Impact:**

Annual operating and maintenance costs are estimated to be \$750 per year.

**Project Completion Date: Aug 2007**

**Expenditure Plan (in \$000's):**

	<u>Total Est Cost</u>	<u>Prior Yrs Funding</u>	<u>FY 05</u>	<u>FY 06</u>	<u>FY 07</u>	<u>FY 08</u>	<u>FY 09</u>	<u>Future</u>
Development	0	0	0	0	0	0	0	0
Design	39	0	39	0	0	0	0	0
Land/ROW	61	0	61	0	0	0	0	0
Construction	200	0	0	100	100	0	0	0
Equipment	0	0	0	0	0	0	0	0
Administration	0	0	0	0	0	0	0	0
<b>Total</b>	<b>\$300</b>	<b>\$0</b>	<b>\$100</b>	<b>\$100</b>	<b>\$100</b>	<b>\$0</b>	<b>\$0</b>	<b>\$0</b>

**Funding Sources (in \$000's):**

	<u>Total Est Cost</u>	<u>Prior Yrs Funding</u>	<u>FY 05</u>	<u>FY 06</u>	<u>FY 07</u>	<u>FY 08</u>	<u>FY 09</u>	<u>Future</u>
Stormwater	300	0	100	100	100	0	0	0
<b>Total</b>	<b>\$300</b>	<b>\$0</b>	<b>\$100</b>	<b>\$100</b>	<b>\$100</b>	<b>\$0</b>	<b>\$0</b>	<b>\$0</b>