









**PROJECT TITLE:**

**PROJECT NO: 41069**

**CRAFT ROAD CULVERT REPLACEMENTS AND STORMWATER DETENTION FACILITY**

**CIE REQUIREMENT: Y**

**LEVEL OF SERVICE IMPACT: M**

**PROGRAM: STORMWATER**

**Project Description:**

Replacement of the Craft Road, Church Road and Bryan Road culverts is recommended to achieve a full 25-year flooding level of service along this reach of the channel. In addition, a 3.4 acre stormwater detention pond located on vacant land east of the Southpointe subdivision is proposed to attenuate the downstream peak flows.

**Neighborhood Community Area:**

Brandon (Central)

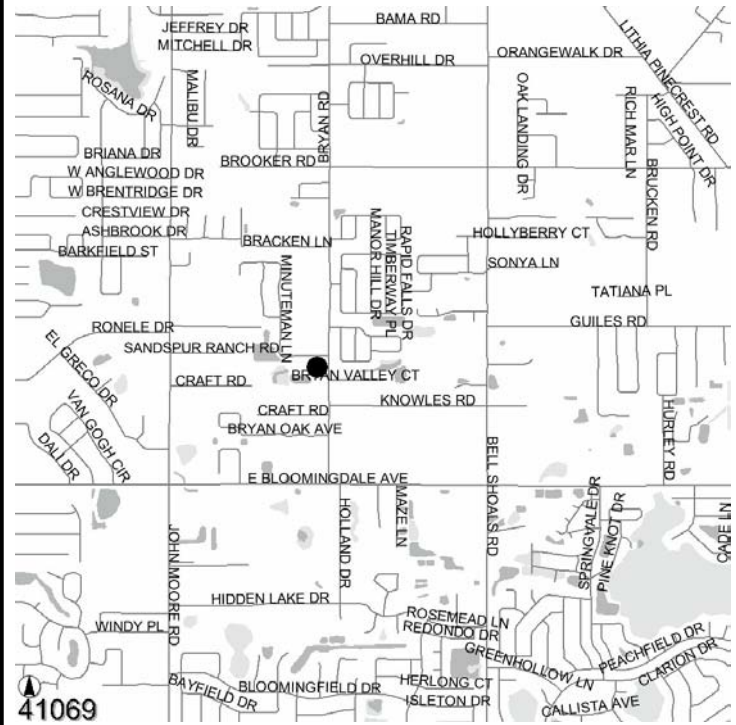

**Operating Cost Impact:**

Annual operating and maintenance costs are estimated to be \$3,760 per year.

**Project Completion Date: Aug 2005**

**Expenditure Plan (in \$000's):**

	<u>Total Est Cost</u>	<u>Prior Yrs Funding</u>	<u>FY 05</u>	<u>FY 06</u>	<u>FY 07</u>	<u>FY 08</u>	<u>FY 09</u>	<u>Future</u>
Development	0	0	0	0	0	0	0	0
Design	63	63	0	0	0	0	0	0
Land/ROW	686	0	261	61	364	0	0	0
Construction	752	0	0	0	136	200	250	166
Equipment	0	0	0	0	0	0	0	0
Administration	3	0	3	0	0	0	0	0
<b>Total</b>	<b>\$1,504</b>	<b>\$63</b>	<b>\$264</b>	<b>\$61</b>	<b>\$500</b>	<b>\$200</b>	<b>\$250</b>	<b>\$166</b>

**Funding Sources (in \$000's):**

	<u>Total Est Cost</u>	<u>Prior Yrs Funding</u>	<u>FY 05</u>	<u>FY 06</u>	<u>FY 07</u>	<u>FY 08</u>	<u>FY 09</u>	<u>Future</u>
Stormwater	1,504	63	264	61	500	200	250	166
<b>Total</b>	<b>\$1,504</b>	<b>\$63</b>	<b>\$264</b>	<b>\$61</b>	<b>\$500</b>	<b>\$200</b>	<b>\$250</b>	<b>\$166</b>