





**CIE REQUIREMENT:** Y

**LEVEL OF SERVICE IMPACT:** M

**PROGRAM:** STORMWATER

**Project Description:**

Implement recommendations identified in the consultant's report for critical locations within the Pemberton/Baker Creek area.

**Neighborhood Community Area:**

Seffner (East)

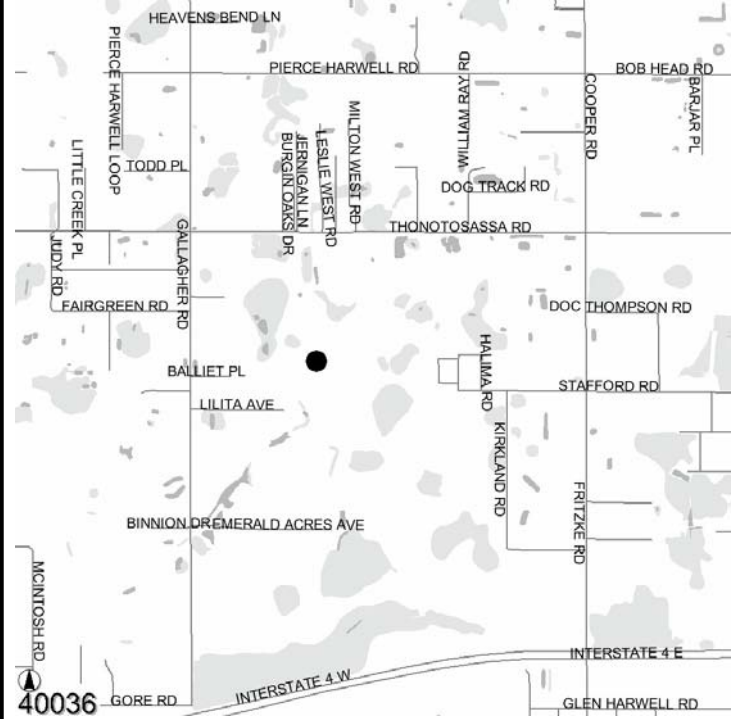

**Operating Cost Impact:**

Annual operating and maintenance costs are estimated to be \$300 per year.

**Project Completion Date:** Aug 2012

**Expenditure Plan (in \$000's):**

	<u>Total Est Cost</u>	<u>Prior Yrs Funding</u>	<u>FY 05</u>	<u>FY 06</u>	<u>FY 07</u>	<u>FY 08</u>	<u>FY 09</u>	<u>Future</u>
Development	0	0	0	0	0	0	0	0
Design	125	0	0	50	0	50	25	0
Land/ROW	0	0	0	0	0	0	0	0
Construction	175	0	0	100	0	50	25	0
Equipment	0	0	0	0	0	0	0	0
Administration	0	0	0	0	0	0	0	0
<b>Total</b>	<b>\$300</b>	<b>\$0</b>	<b>\$0</b>	<b>\$150</b>	<b>\$0</b>	<b>\$100</b>	<b>\$50</b>	<b>\$0</b>

**Funding Sources (in \$000's):**

	<u>Total Est Cost</u>	<u>Prior Yrs Funding</u>	<u>FY 05</u>	<u>FY 06</u>	<u>FY 07</u>	<u>FY 08</u>	<u>FY 09</u>	<u>Future</u>
Stormwater	300	0	0	150	0	100	50	0
<b>Total</b>	<b>\$300</b>	<b>\$0</b>	<b>\$0</b>	<b>\$150</b>	<b>\$0</b>	<b>\$100</b>	<b>\$50</b>	<b>\$0</b>



