

Project Description:

Begin design and right of way acquisition to implement consultant recommendations for stormwater improvements within the Silver/ Twin Lake watershed.

Neighborhood Community Area:

Town N' Country (Northwest)



Operating Cost Impact:

Annual operating and maintenance costs are estimated to be \$1,278 per year.

Project Completion Date: Jul 2005

Expenditure Plan (in \$000's):

	<u>Total Est Cost</u>	<u>Prior Yrs Funding</u>	<u>FY 05</u>	<u>FY 06</u>	<u>FY 07</u>	<u>FY 08</u>	<u>FY 09</u>	<u>Future</u>
Development	0	0	0	0	0	0	0	0
Design	11	31	-20	0	0	0	0	0
Land/ROW	0	0	0	0	0	0	0	0
Construction	500	80	200	0	0	150	70	0
Equipment	0	0	0	0	0	0	0	0
Administration	0	0	0	0	0	0	0	0
Total	\$511	\$111	\$180	\$0	\$0	\$150	\$70	\$0

Funding Sources (in \$000's):

	<u>Total Est Cost</u>	<u>Prior Yrs Funding</u>	<u>FY 05</u>	<u>FY 06</u>	<u>FY 07</u>	<u>FY 08</u>	<u>FY 09</u>	<u>Future</u>
Stormwater	511	111	180	0	0	150	70	0
Total	\$511	\$111	\$180	\$0	\$0	\$150	\$70	\$0

PROJECT TITLE:

PROJECT NO: 47344

SLIGH AVENUE STORMWATER IMPROVEMENTS PHASE III

CIE REQUIREMENT: Y

LEVEL OF SERVICE IMPACT: E

PROGRAM: STORMWATER

Project Description:

Design and construct improvements to alleviate flooding along Minnehaha Street and Arlene Street.

Neighborhood Community Area:

Town N' Country (Northwest)

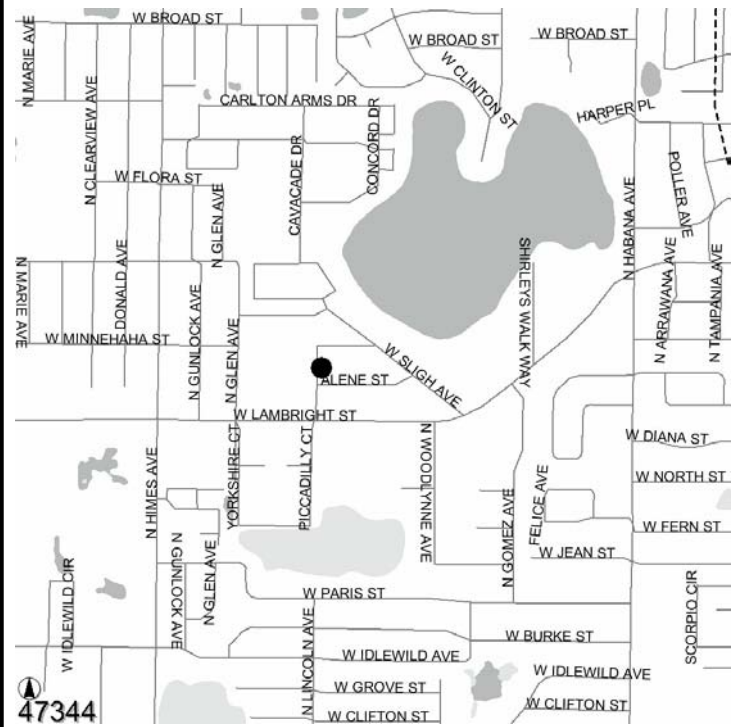

Operating Cost Impact:

Annual operating and maintenance costs are estimated to be \$1,113 per year.

Project Completion Date: Jan 2006

Expenditure Plan (in \$000's):

	<u>Total Est Cost</u>	<u>Prior Yrs Funding</u>	<u>FY 05</u>	<u>FY 06</u>	<u>FY 07</u>	<u>FY 08</u>	<u>FY 09</u>	<u>Future</u>
Development	0	0	0	0	0	0	0	0
Design	25	25	0	0	0	0	0	0
Land/ROW	10	10	0	0	0	0	0	0
Construction	410	0	0	410	0	0	0	0
Equipment	0	0	0	0	0	0	0	0
Administration	0	0	0	0	0	0	0	0
Total	\$445	\$35	\$0	\$410	\$0	\$0	\$0	\$0

Funding Sources (in \$000's):

	<u>Total Est Cost</u>	<u>Prior Yrs Funding</u>	<u>FY 05</u>	<u>FY 06</u>	<u>FY 07</u>	<u>FY 08</u>	<u>FY 09</u>	<u>Future</u>
Stormwater	445	35	0	410	0	0	0	0
Total	\$445	\$35	\$0	\$410	\$0	\$0	\$0	\$0

PROJECT TITLE:

PROJECT NO: 47334

STORMWATER PUMPING STATIONS FY 05

CIE REQUIREMENT: Y

LEVEL OF SERVICE IMPACT: M

PROGRAM: STORMWATER

Project Description:

Revamp and repair the 17 stormwater pumping stations as needed.

Neighborhood Community Area:

Countywide



Operating Cost Impact:

Annual operating and maintenance costs are estimated to be \$125 per year.

Project Completion Date: Aug 2005

Expenditure Plan (in \$000's):

	<u>Total Est Cost</u>	<u>Prior Yrs Funding</u>	<u>FY 05</u>	<u>FY 06</u>	<u>FY 07</u>	<u>FY 08</u>	<u>FY 09</u>	<u>Future</u>
Development	0	0	0	0	0	0	0	0
Design	0	0	0	0	0	0	0	0
Land/ROW	0	0	0	0	0	0	0	0
Construction	50	0	50	0	0	0	0	0
Equipment	0	0	0	0	0	0	0	0
Administration	0	0	0	0	0	0	0	0
Total	\$50	\$0	\$50	\$0	\$0	\$0	\$0	\$0

Funding Sources (in \$000's):

	<u>Total Est Cost</u>	<u>Prior Yrs Funding</u>	<u>FY 05</u>	<u>FY 06</u>	<u>FY 07</u>	<u>FY 08</u>	<u>FY 09</u>	<u>Future</u>
Stormwater	50	0	50	0	0	0	0	0
Total	\$50	\$0	\$50	\$0	\$0	\$0	\$0	\$0