

PROJECT TITLE:
SOUTH CR 39 OVER LITTLE MANATEE RIVER BRIDGE

PROJECT NO: 69202

CIE REQUIREMENT: Y

LEVEL OF SERVICE IMPACT: M

PROGRAM: TRANSPORTATION/BRIDGES

Project Description:

Completely replace bridge #100253.

Neighborhood Community Area:

Balm/Wimauma (South)

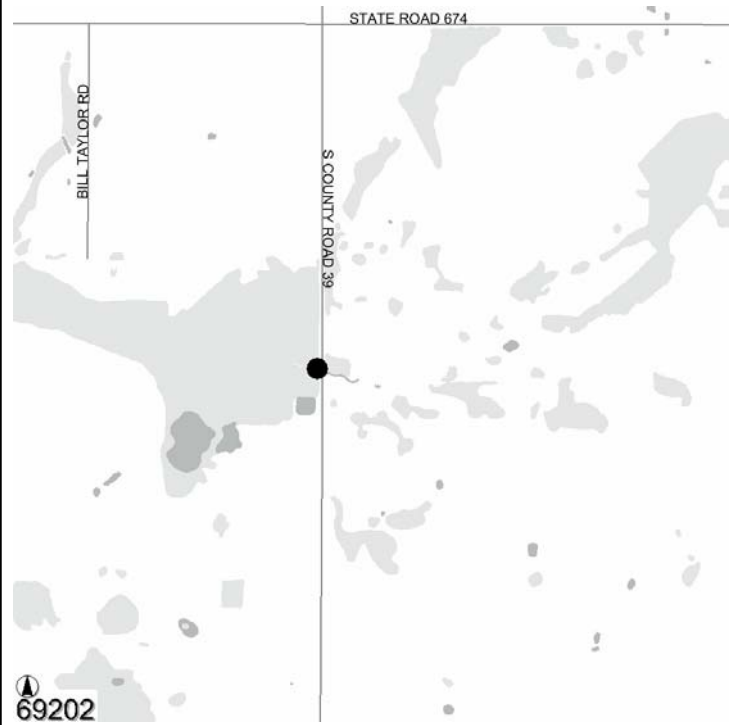

Operating Cost Impact:

Annual operating and maintenance costs are estimated to be \$1,400 per year.

Project Completion Date: Jul 2005

Expenditure Plan (in \$000's):

	<u>Total Est Cost</u>	<u>Prior Yrs Funding</u>	<u>FY 05</u>	<u>FY 06</u>	<u>FY 07</u>	<u>FY 08</u>	<u>FY 09</u>	<u>Future</u>
Development	96	96	0	0	0	0	0	0
Design	295	201	94	0	0	0	0	0
Land/ROW	20	20	0	0	0	0	0	0
Construction	1,869	736	1,133	0	0	0	0	0
Equipment	0	0	0	0	0	0	0	0
Administration	0	0	0	0	0	0	0	0
Total	\$2,280	\$1,053	\$1,227	\$0	\$0	\$0	\$0	\$0

Funding Sources (in \$000's):

	<u>Total Est Cost</u>	<u>Prior Yrs Funding</u>	<u>FY 05</u>	<u>FY 06</u>	<u>FY 07</u>	<u>FY 08</u>	<u>FY 09</u>	<u>Future</u>
Financing - CIT Backed	2,280	1,053	1,227	0	0	0	0	0
Total	\$2,280	\$1,053	\$1,227	\$0	\$0	\$0	\$0	\$0

PROJECT TITLE:
SYMMES ROAD OVER BULLFROG CREEK BRIDGE

PROJECT NO: 69214

CIE REQUIREMENT: Y
LEVEL OF SERVICE IMPACT: M

PROGRAM: TRANSPORTATION/BRIDGES

Project Description:

Completely replace bridge #104310.

Neighborhood Community Area:

Riverview/Boyette (Central)

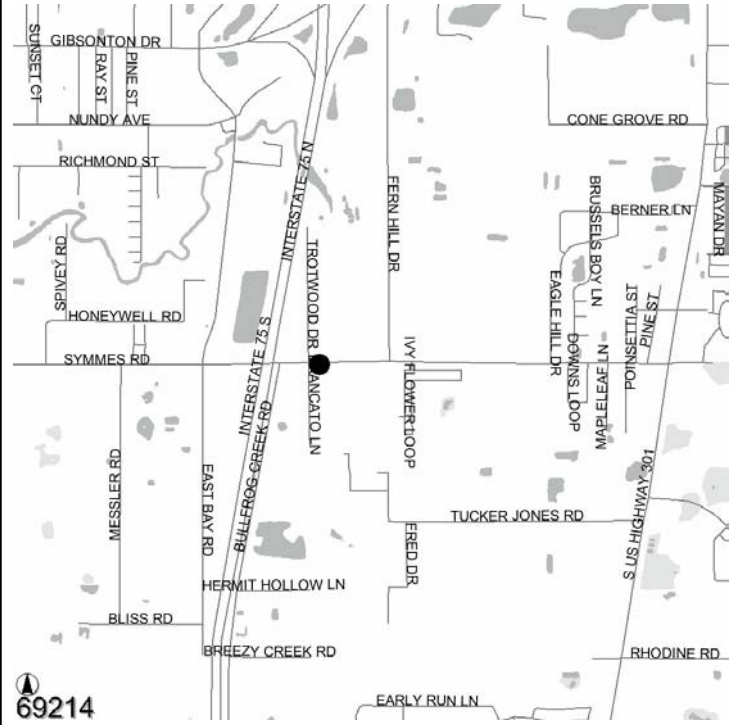

Operating Cost Impact:

Annual operating and maintenance costs are estimated to be \$1,400 per year.

Project Completion Date: May 2005

Expenditure Plan (in \$000's):

	<u>Total Est Cost</u>	<u>Prior Yrs Funding</u>	<u>FY 05</u>	<u>FY 06</u>	<u>FY 07</u>	<u>FY 08</u>	<u>FY 09</u>	<u>Future</u>
Development	115	115	0	0	0	0	0	0
Design	297	240	57	0	0	0	0	0
Land/ROW	0	40	-40	0	0	0	0	0
Construction	1,744	1,670	74	0	0	0	0	0
Equipment	0	0	0	0	0	0	0	0
Administration	0	0	0	0	0	0	0	0
Total	\$2,156	\$2,065	\$91	\$0	\$0	\$0	\$0	\$0

Funding Sources (in \$000's):

	<u>Total Est Cost</u>	<u>Prior Yrs Funding</u>	<u>FY 05</u>	<u>FY 06</u>	<u>FY 07</u>	<u>FY 08</u>	<u>FY 09</u>	<u>Future</u>
Financing - CIT Backed	2,156	2,065	91	0	0	0	0	0
Total	\$2,156	\$2,065	\$91	\$0	\$0	\$0	\$0	\$0

PROJECT TITLE:

WEBB ROAD OVER SWEETWATER CREEK/CHANNEL G BRIDGE

PROJECT NO: 69211

CIE REQUIREMENT: Y

LEVEL OF SERVICE IMPACT: M

PROGRAM: TRANSPORTATION/BRIDGES

Project Description:

Completely replace bridge #104217.

Neighborhood Community Area:

Town N' Country (Northwest)

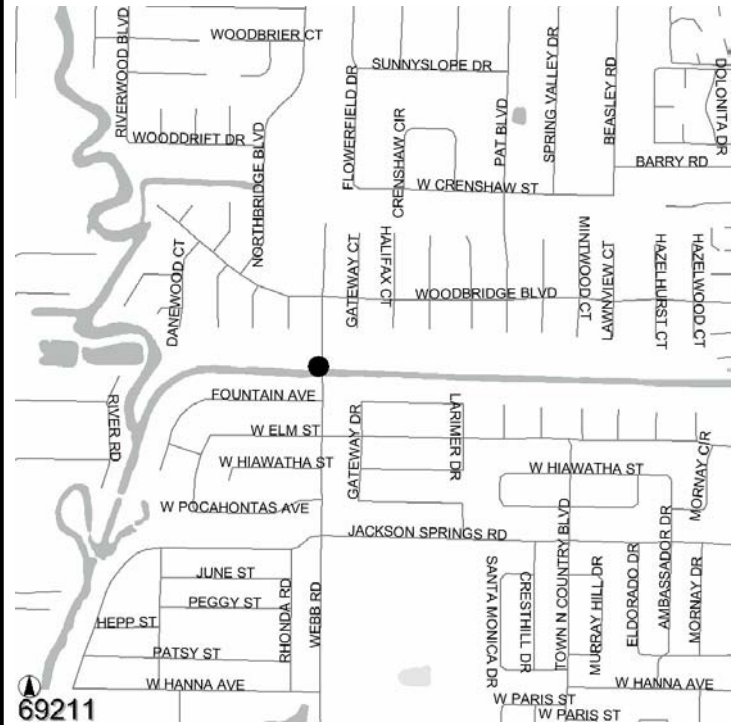

Operating Cost Impact:

Annual operating and maintenance costs are estimated to be \$1,400 per year.

Project Completion Date: Oct 2004

Expenditure Plan (in \$000's):

	<u>Total Est Cost</u>	<u>Prior Yrs Funding</u>	<u>FY 05</u>	<u>FY 06</u>	<u>FY 07</u>	<u>FY 08</u>	<u>FY 09</u>	<u>Future</u>
Development	109	115	-6	0	0	0	0	0
Design	209	207	2	0	0	0	0	0
Land/ROW	0	200	-200	0	0	0	0	0
Construction	1,477	1,295	182	0	0	0	0	0
Equipment	0	0	0	0	0	0	0	0
Administration	0	0	0	0	0	0	0	0
Total	\$1,795	\$1,817	-\$22	\$0	\$0	\$0	\$0	\$0

Funding Sources (in \$000's):

	<u>Total Est Cost</u>	<u>Prior Yrs Funding</u>	<u>FY 05</u>	<u>FY 06</u>	<u>FY 07</u>	<u>FY 08</u>	<u>FY 09</u>	<u>Future</u>
Financing - CIT Backed	1,795	1,817	-22	0	0	0	0	0
Total	\$1,795	\$1,817	-\$22	\$0	\$0	\$0	\$0	\$0

PROJECT TITLE:PROJECT NO: 62231**WEST COLUMBUS DRIVE OVER HILLSBOROUGH RIVER BRIDGE REPAIRS**

CIE REQUIREMENT: Y

LEVEL OF SERVICE IMPACT: M

PROGRAM: TRANSPORTATION/BRIDGES

Project Description:

The existing movable bridge structure is in a deteriorated condition. Heavily corroded steel bottom lateral bracing members have fallen off the structure. The mechanical systems are showing signs of wear and misalignment. The project consists of repairs to the mechanical and electrical systems of a movable bridge. Also, the corroded structural steel in the lower portions of the swing span need to be cleaned of rust and lead paint and repaired or replaced. Additionally, the center bearing will be evaluated, with the proposed replacement to be designed and constructed.

Neighborhood Community Area:

City of Tampa

**Operating Cost Impact:**

No change in operating and maintenance costs is anticipated.

Project Completion Date: Nov 2005**Expenditure Plan (in \$000's):**

	<u>Total Est Cost</u>	<u>Prior Yrs Funding</u>	<u>FY 05</u>	<u>FY 06</u>	<u>FY 07</u>	<u>FY 08</u>	<u>FY 09</u>	<u>Future</u>
Development	39	51	-12	0	0	0	0	0
Design	186	150	36	0	0	0	0	0
Land/ROW	0	0	0	0	0	0	0	0
Construction	971	999	-28	0	0	0	0	0
Equipment	0	0	0	0	0	0	0	0
Administration	0	0	0	0	0	0	0	0
Total	\$1,196	\$1,200	-\$4	\$0	\$0	\$0	\$0	\$0

Funding Sources (in \$000's):

	<u>Total Est Cost</u>	<u>Prior Yrs Funding</u>	<u>FY 05</u>	<u>FY 06</u>	<u>FY 07</u>	<u>FY 08</u>	<u>FY 09</u>	<u>Future</u>
Gas Taxes	1,196	1,200	-4	0	0	0	0	0
Total	\$1,196	\$1,200	-\$4	\$0	\$0	\$0	\$0	\$0

