

PROJECT TITLE:

PROJECT NO: 89313

TEMPLE TERRACE BY-PASS CANAL LAND ACQUISITION (CIT II)

CIE REQUIREMENT: Y

LEVEL OF SERVICE IMPACT: F

PROGRAM: PARKS

Project Description:

To acquire 95 acres of land on the Tampa By-Pass Canal to allow for expansion of the Temple Terrace Sports Complex.

Neighborhood Community Area:

Temple Terrace (City)

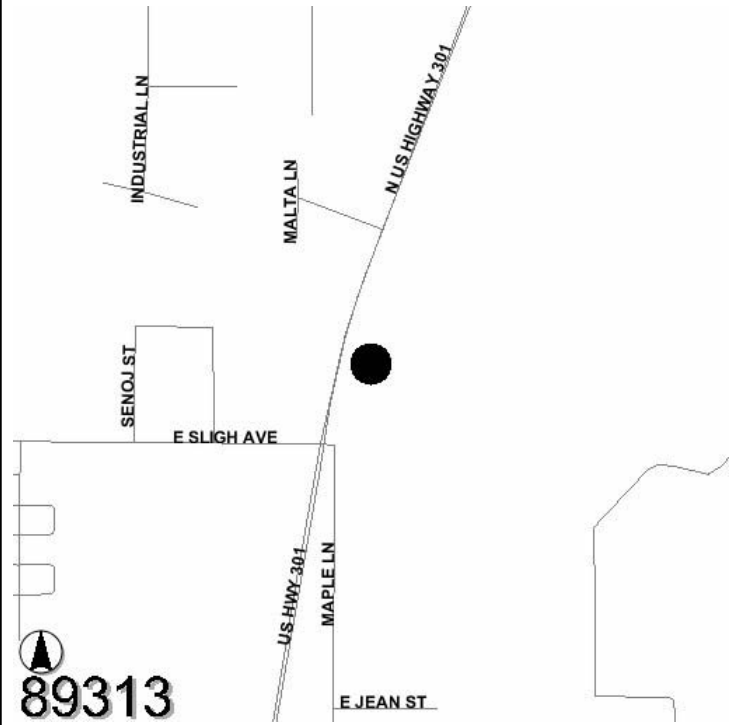

Operating Cost Impact:

None

Project Completion Date: Oct 2008

Expenditure Plan (in \$000's):

	<u>Total Est Cost</u>	<u>Prior Yrs Funding</u>	<u>FY 06</u>	<u>FY 07</u>	<u>FY 08</u>	<u>FY 09</u>	<u>FY 10</u>	<u>FY 11</u>	<u>Future</u>
Development	0	0	0	0	0	0	0	0	0
Design	0	0	0	0	0	0	0	0	0
Land/ROW	400	0	0	400	0	0	0	0	0
Construction	0	0	0	0	0	0	0	0	0
Equipment	0	0	0	0	0	0	0	0	0
Administration	0	0	0	0	0	0	0	0	0
Total	\$400	\$0	\$0	\$400	\$0	\$0	\$0	\$0	\$0

Funding Sources (in \$000's):

	<u>Total Est Cost</u>	<u>Prior Yrs Funding</u>	<u>FY 06</u>	<u>FY 07</u>	<u>FY 08</u>	<u>FY 09</u>	<u>FY 10</u>	<u>FY 11</u>	<u>Future</u>
Financing - CIT Backed	400	0	0	400	0	0	0	0	0
Total	\$400	\$0	\$0	\$400	\$0	\$0	\$0	\$0	\$0

PROJECT TITLE:

PROJECT NO: 89314

TOWN N' COUNTRY/SHIMBERG SOCCER FIELD EXPANSION (CIT II)

CIE REQUIREMENT: Y

LEVEL OF SERVICE IMPACT: F

PROGRAM: PARKS

Project Description:

Construct additional soccer fields at Shimberg Park in Town N' County.

Neighborhood Community Area:

Town N' Country (Northwest)

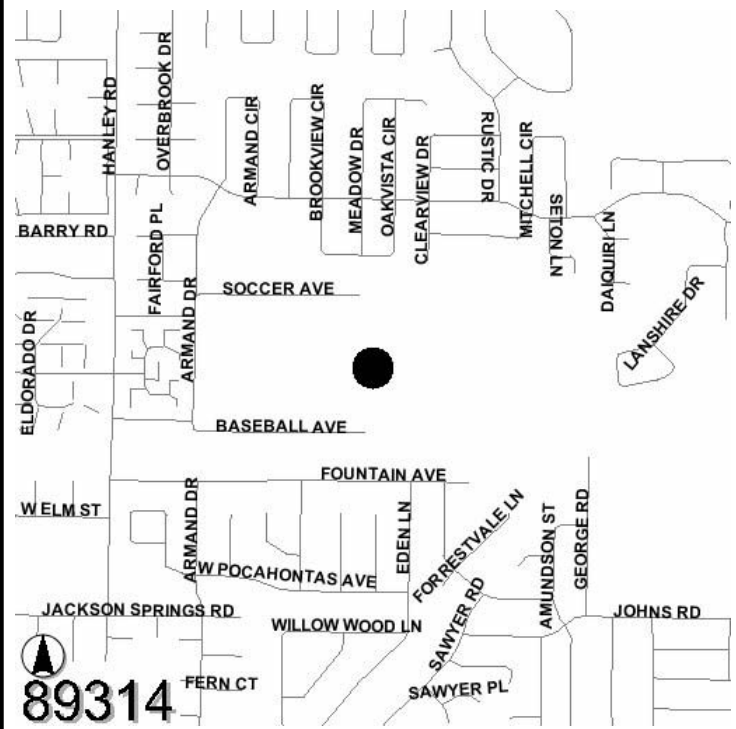

Operating Cost Impact:

Operating cost is estimated to be \$135,667 in FY 09 and \$146,000 thereafter.

Project Completion Date: Oct 2008

Expenditure Plan (in \$000's):

	<u>Total Est Cost</u>	<u>Prior Yrs Funding</u>	<u>FY 06</u>	<u>FY 07</u>	<u>FY 08</u>	<u>FY 09</u>	<u>FY 10</u>	<u>FY 11</u>	<u>Future</u>
Development	37	0	0	37	0	0	0	0	0
Design	0	0	0	0	0	0	0	0	0
Land/ROW	0	0	0	0	0	0	0	0	0
Construction	685	0	0	155	530	0	0	0	0
Equipment	0	0	0	0	0	0	0	0	0
Administration	28	0	0	8	20	0	0	0	0
Total	\$750	\$0	\$0	\$200	\$550	\$0	\$0	\$0	\$0

Funding Sources (in \$000's):

	<u>Total Est Cost</u>	<u>Prior Yrs Funding</u>	<u>FY 06</u>	<u>FY 07</u>	<u>FY 08</u>	<u>FY 09</u>	<u>FY 10</u>	<u>FY 11</u>	<u>Future</u>
Financing - CIT Backed	750	0	0	200	550	0	0	0	0
Total	\$750	\$0	\$0	\$200	\$550	\$0	\$0	\$0	\$0