

PROJECT TITLE:

PROJECT NO: 47159

HILLSBOROUGH RIVER/TAMPA BYPASS CANAL STORMWATER PLAN IMPLEMENTATION

CIE REQUIREMENT: Y

LEVEL OF SERVICE IMPACT: E

PROGRAM: STORMWATER

Project Description:

Begin design and right-of-way acquisition to implement consultant recommendations for stormwater improvements within the Hillsborough River/Tampa Bypass Canal watershed.

Neighborhood Community Area:

Various



Operating Cost Impact:

Annual operating and maintenance costs are estimated to be \$1,550 per year.

Project Completion Date: Sep 2011

Expenditure Plan (in \$000's):

	<u>Total Est Cost</u>	<u>Prior Yrs Funding</u>	<u>FY 06</u>	<u>FY 07</u>	<u>FY 08</u>	<u>FY 09</u>	<u>FY 10</u>	<u>FY 11</u>	<u>Future</u>
Development	0	0	0	0	0	0	0	0	0
Design	620	120	0	0	0	0	250	250	0
Land/ROW	0	0	0	0	0	0	0	0	0
Construction	0	0	0	0	0	0	0	0	0
Equipment	0	0	0	0	0	0	0	0	0
Administration	0	0	0	0	0	0	0	0	0
Total	\$620	\$120	\$0	\$0	\$0	\$0	\$250	\$250	\$0

Funding Sources (in \$000's):

	<u>Total Est Cost</u>	<u>Prior Yrs Funding</u>	<u>FY 06</u>	<u>FY 07</u>	<u>FY 08</u>	<u>FY 09</u>	<u>FY 10</u>	<u>FY 11</u>	<u>Future</u>
Stormwater	620	120	0	0	0	0	250	250	0
Total	\$620	\$120	\$0	\$0	\$0	\$0	\$250	\$250	\$0

PROJECT TITLE:

PROJECT NO: 41072

HOLLOMANS BRANCH STORMWATER IMPROVEMENTS - HBA 1A

CIE REQUIREMENT: Y

LEVEL OF SERVICE IMPACT: M

PROGRAM: STORMWATER

Project Description:

Culvert replacement, channel clean and snagging - McIntosh Road and Groom Road.

Neighborhood Community Area:

Knights/Antioch (Northeast)



Operating Cost Impact:

Annual operating and maintenance costs are estimated to be \$1,758 per year.

Project Completion Date: Sep 2008

Expenditure Plan (in \$000's):

	<u>Total Est Cost</u>	<u>Prior Yrs Funding</u>	<u>FY 06</u>	<u>FY 07</u>	<u>FY 08</u>	<u>FY 09</u>	<u>FY 10</u>	<u>FY 11</u>	<u>Future</u>
Development	0	0	0	0	0	0	0	0	0
Design	39	39	0	0	0	0	0	0	0
Land/ROW	0	0	0	0	0	0	0	0	0
Construction	664	211	79	310	64	0	0	0	0
Equipment	0	0	0	0	0	0	0	0	0
Administration	0	0	0	0	0	0	0	0	0
Total	\$703	\$250	\$79	\$310	\$64	\$0	\$0	\$0	\$0

Funding Sources (in \$000's):

	<u>Total Est Cost</u>	<u>Prior Yrs Funding</u>	<u>FY 06</u>	<u>FY 07</u>	<u>FY 08</u>	<u>FY 09</u>	<u>FY 10</u>	<u>FY 11</u>	<u>Future</u>
Stormwater	703	250	79	310	64	0	0	0	0
Total	\$703	\$250	\$79	\$310	\$64	\$0	\$0	\$0	\$0

PROJECT TITLE:
HOLLOMANS BRANCH STORMWATER IMPROVEMENTS - HBA 6C

PROJECT NO: 41073

CIE REQUIREMENT: Y

LEVEL OF SERVICE IMPACT: M

PROGRAM: STORMWATER

Project Description:

Culvert replacement and installation of wetland treatment area - Peeples Road.

Neighborhood Community Area:

East Hillsborough (Northeast)

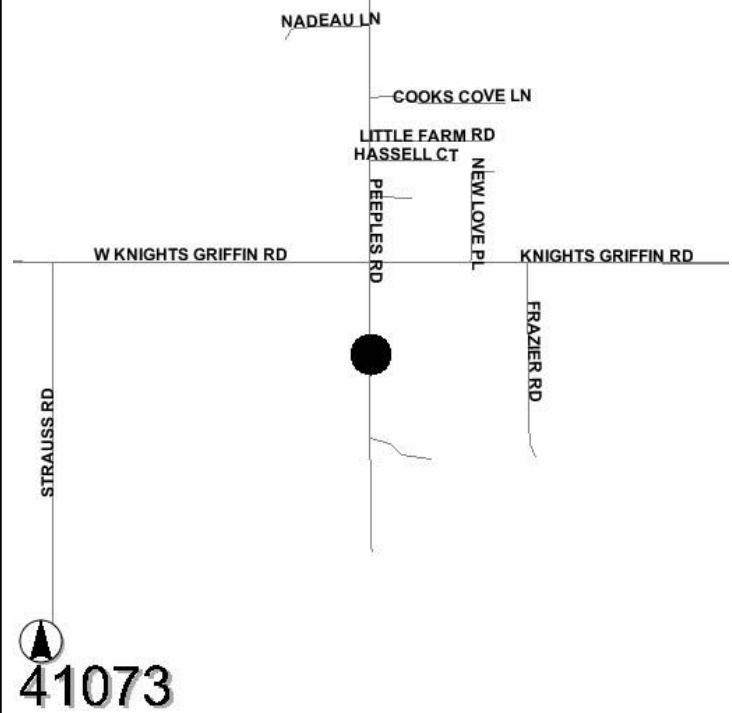

Operating Cost Impact:

Annual operating and maintenance costs are estimated to be \$4,100 per year.

Project Completion Date: Aug 2011

Expenditure Plan (in \$000's):

	<u>Total Est Cost</u>	<u>Prior Yrs Funding</u>	<u>FY 06</u>	<u>FY 07</u>	<u>FY 08</u>	<u>FY 09</u>	<u>FY 10</u>	<u>FY 11</u>	<u>Future</u>
Development	0	0	0	0	0	0	0	0	0
Design	39	39	0	0	0	0	0	0	0
Land/ROW	481	21	10	10	108	150	182	0	0
Construction	1,120	0	0	0	0	0	1,120	0	0
Equipment	0	0	0	0	0	0	0	0	0
Administration	0	0	0	0	0	0	0	0	0
Total	\$1,640	\$60	\$10	\$10	\$108	\$150	\$1,302	\$0	\$0

Funding Sources (in \$000's):

	<u>Total Est Cost</u>	<u>Prior Yrs Funding</u>	<u>FY 06</u>	<u>FY 07</u>	<u>FY 08</u>	<u>FY 09</u>	<u>FY 10</u>	<u>FY 11</u>	<u>Future</u>
Stormwater	1,640	60	10	10	108	150	1,302	0	0
Total	\$1,640	\$60	\$10	\$10	\$108	\$150	\$1,302	\$0	\$0

PROJECT TITLE:
HOPE LANE STORMWATER IMPROVEMENTS

PROJECT NO: 41062

CIE REQUIREMENT: Y
LEVEL OF SERVICE IMPACT: M

PROGRAM: STORMWATER

Project Description:

Conveyance system to Lake Carroll will be upgraded.

Neighborhood Community Area:

Carrollwood (North Tampa)

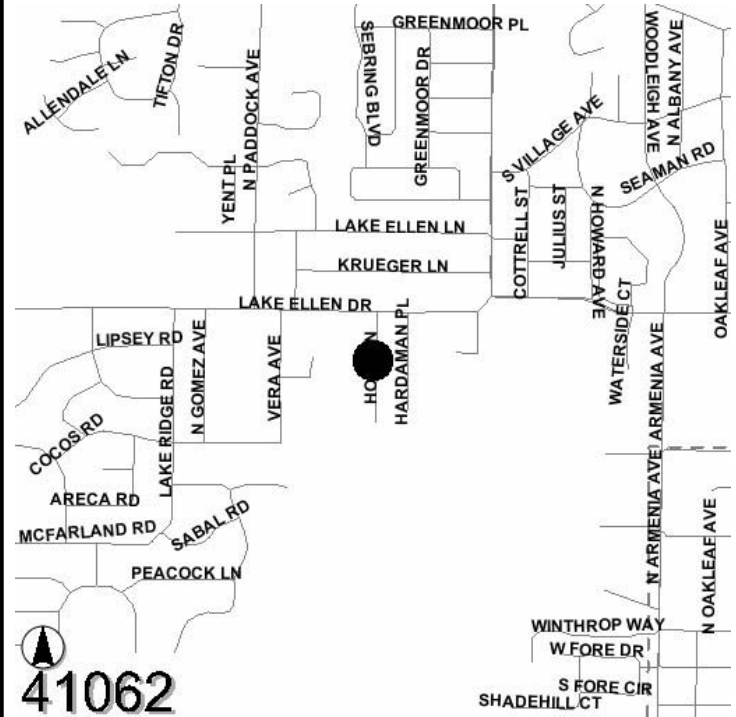

Operating Cost Impact:

Annual operating and maintenance costs are estimated to be \$363 per year.

Project Completion Date: Jul 2007

Expenditure Plan (in \$000's):

	<u>Total Est Cost</u>	<u>Prior Yrs Funding</u>	<u>FY 06</u>	<u>FY 07</u>	<u>FY 08</u>	<u>FY 09</u>	<u>FY 10</u>	<u>FY 11</u>	<u>Future</u>
Development	0	0	0	0	0	0	0	0	0
Design	39	39	0	0	0	0	0	0	0
Land/ROW	10	0	10	0	0	0	0	0	0
Construction	96	0	0	96	0	0	0	0	0
Equipment	0	0	0	0	0	0	0	0	0
Administration	0	0	0	0	0	0	0	0	0
Total	\$145	\$39	\$10	\$96	\$0	\$0	\$0	\$0	\$0

Funding Sources (in \$000's):

	<u>Total Est Cost</u>	<u>Prior Yrs Funding</u>	<u>FY 06</u>	<u>FY 07</u>	<u>FY 08</u>	<u>FY 09</u>	<u>FY 10</u>	<u>FY 11</u>	<u>Future</u>
Stormwater	145	39	10	96	0	0	0	0	0
Total	\$145	\$39	\$10	\$96	\$0	\$0	\$0	\$0	\$0

PROJECT TITLE:

PROJECT NO: 41063

HUTCHINSON ROAD OUTFALL PROJECT

CIE REQUIREMENT: Y

LEVEL OF SERVICE IMPACT: M

PROGRAM: STORMWATER

Project Description:

Construct a new outfall by purchasing an easement across the properties at 16569 and 16573 Hutchinson Road. Build inlets on both sides of Hutchinson Road and pipe to Lake Josephine.

Neighborhood Community Area:

Keystone (Northwest)

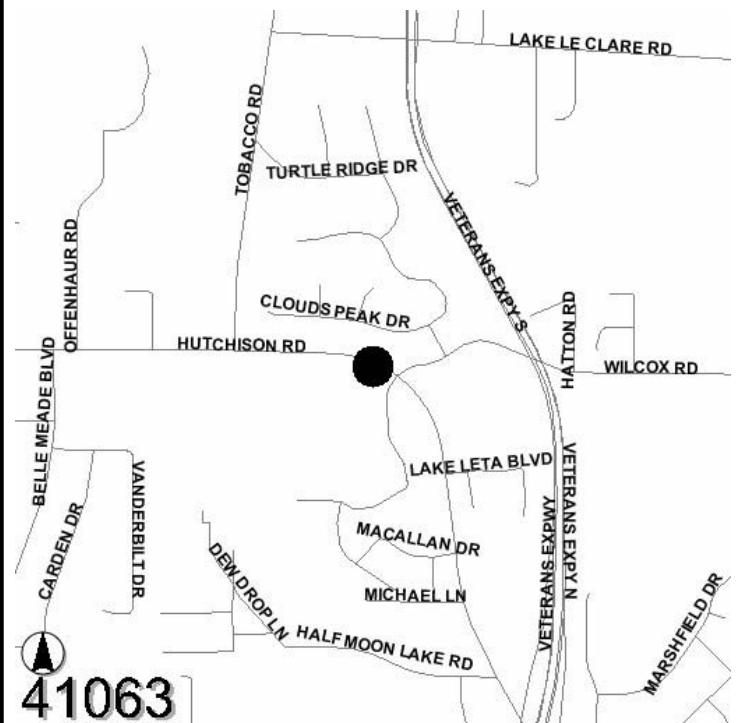

Operating Cost Impact:

Annual operating and maintenance costs are estimated to be \$213 per year.

Project Completion Date: Aug 2008

Expenditure Plan (in \$000's):

	<u>Total Est Cost</u>	<u>Prior Yrs Funding</u>	<u>FY 06</u>	<u>FY 07</u>	<u>FY 08</u>	<u>FY 09</u>	<u>FY 10</u>	<u>FY 11</u>	<u>Future</u>
Development	0	0	0	0	0	0	0	0	0
Design	39	39	0	0	0	0	0	0	0
Land/ROW	10	0	10	0	0	0	0	0	0
Construction	36	0	0	36	0	0	0	0	0
Equipment	0	0	0	0	0	0	0	0	0
Administration	0	0	0	0	0	0	0	0	0
Total	\$85	\$39	\$10	\$36	\$0	\$0	\$0	\$0	\$0

Funding Sources (in \$000's):

	<u>Total Est Cost</u>	<u>Prior Yrs Funding</u>	<u>FY 06</u>	<u>FY 07</u>	<u>FY 08</u>	<u>FY 09</u>	<u>FY 10</u>	<u>FY 11</u>	<u>Future</u>
Stormwater	85	39	10	36	0	0	0	0	0
Total	\$85	\$39	\$10	\$36	\$0	\$0	\$0	\$0	\$0