

PROJECT TITLE:

PROJECT NO: 40038

LOWER SWEETWATER CREEK STORMWATER PLAN IMPLEMENTATION

CIE REQUIREMENT: Y

LEVEL OF SERVICE IMPACT: E

PROGRAM: STORMWATER

Project Description:

Implement recommendations identified in the consultant's report for critical locations within the Lower Sweetwater Creek area.

Neighborhood Community Area:

Town N' Country (Northwest)

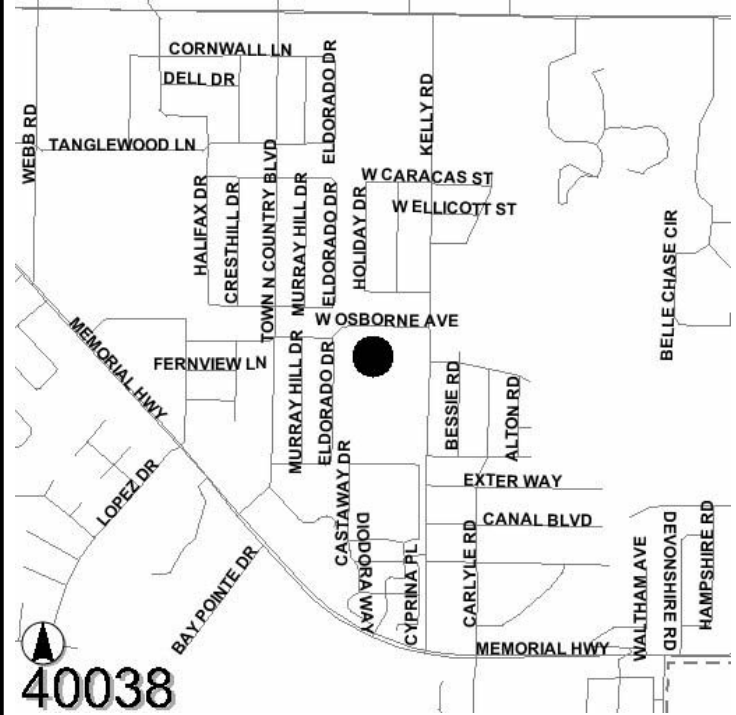

Operating Cost Impact:

Annual operating and maintenance costs are estimated to be \$865 per year.

Project Completion Date: Aug 2012

Expenditure Plan (in \$000's):

| | <u>Total Est Cost</u> | <u>Prior Yrs Funding</u> | <u>FY 06</u> | <u>FY 07</u> | <u>FY 08</u> | <u>FY 09</u> | <u>FY 10</u> | <u>FY 11</u> | <u>Future</u> |
|----------------|-----------------------|--------------------------|--------------|--------------|--------------|--------------|--------------|--------------|---------------|
| Development | 0 | 0 | 0 | 0 | 0 | 0 | 0 | 0 | 0 |
| Design | 15 | 15 | 0 | 0 | 0 | 0 | 0 | 0 | 0 |
| Land/ROW | 0 | 0 | 0 | 0 | 0 | 0 | 0 | 0 | 0 |
| Construction | 331 | 85 | 0 | 0 | 46 | 200 | 0 | 0 | 0 |
| Equipment | 0 | 0 | 0 | 0 | 0 | 0 | 0 | 0 | 0 |
| Administration | 0 | 0 | 0 | 0 | 0 | 0 | 0 | 0 | 0 |
| Total | \$346 | \$100 | \$0 | \$0 | \$46 | \$200 | \$0 | \$0 | \$0 |

Funding Sources (in \$000's):

| | <u>Total Est Cost</u> | <u>Prior Yrs Funding</u> | <u>FY 06</u> | <u>FY 07</u> | <u>FY 08</u> | <u>FY 09</u> | <u>FY 10</u> | <u>FY 11</u> | <u>Future</u> |
|--------------|-----------------------|--------------------------|--------------|--------------|--------------|--------------|--------------|--------------|---------------|
| Stormwater | 346 | 100 | 0 | 0 | 46 | 200 | 0 | 0 | 0 |
| Total | \$346 | \$100 | \$0 | \$0 | \$46 | \$200 | \$0 | \$0 | \$0 |

