

PROJECT TITLE:

PROJECT NO: 41080

WOLF BRANCH CULVERT REPLACEMENTS

CIE REQUIREMENT: Y

LEVEL OF SERVICE IMPACT: M

PROGRAM: STORMWATER

Project Description:

Replace existing culverts at 19th Avenue with a 4' x 5' box culvert to provide adequate conveyance capacity. Replace existing culverts at 12th Street with twin 5' x 7' box culverts to provide adequate conveyance capacity, raise the roadbed a maximum of 3 inches, and reconstruct 1,300 feet of roadway to elevate the driving surface out of the floodplain.

Neighborhood Community Area:

Apollo Beach (South)

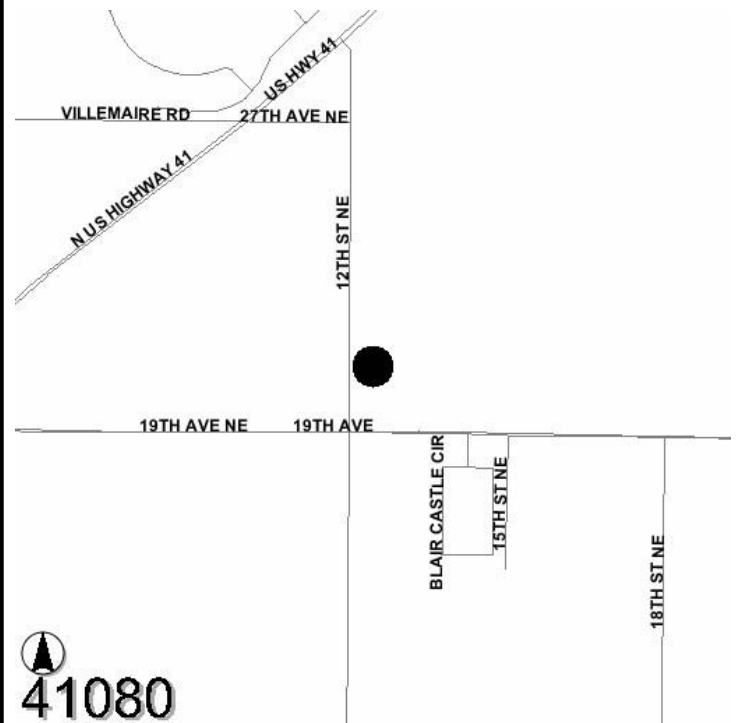

Operating Cost Impact:

Annual operating and maintenance costs are estimated to be \$900 per year.

Project Completion Date: Aug 2008

Expenditure Plan (in \$000's):

	<u>Total Est Cost</u>	<u>Prior Yrs Funding</u>	<u>FY 06</u>	<u>FY 07</u>	<u>FY 08</u>	<u>FY 09</u>	<u>FY 10</u>	<u>FY 11</u>	<u>Future</u>
Development	0	0	0	0	0	0	0	0	0
Design	60	60	0	0	0	0	0	0	0
Land/ROW	0	0	0	0	0	0	0	0	0
Construction	300	58	100	0	142	0	0	0	0
Equipment	0	0	0	0	0	0	0	0	0
Administration	0	0	0	0	0	0	0	0	0
Total	\$360	\$118	\$100	\$0	\$142	\$0	\$0	\$0	\$0

Funding Sources (in \$000's):

	<u>Total Est Cost</u>	<u>Prior Yrs Funding</u>	<u>FY 06</u>	<u>FY 07</u>	<u>FY 08</u>	<u>FY 09</u>	<u>FY 10</u>	<u>FY 11</u>	<u>Future</u>
Stormwater	360	118	100	0	142	0	0	0	0
Total	\$360	\$118	\$100	\$0	\$142	\$0	\$0	\$0	\$0

