

**PROJECT TITLE:**

**PROJECT NO:** 62117

**CONSOLIDATED BRIDGE AND GUARDRAIL REHABILITATION AND REPAIR FY 08**

**CIE REQUIREMENT:** Y

**LEVEL OF SERVICE IMPACT:** M

**PROGRAM:** TRANSPORTATION/BRIDGES

**Project Description:**

Rehab and repair of several County bridges, and rehab and repair of guardrail within County ROW. Scope includes rehab/repair of substructure, pre-stressed concrete deck spans, pile jackets and scour mitigation efforts, in addition to repair and replacing guardrail as required.

**Neighborhood Community Area:**

Countywide



**Operating Cost Impact:**

No change in annual operating and maintenance costs is anticipated.

**Project Completion Date:** Sep 2008

**Expenditure Plan (in \$000's):**

	<u>Total Est Cost</u>	<u>Prior Yrs Funding</u>	<u>FY 06</u>	<u>FY 07</u>	<u>FY 08</u>	<u>FY 09</u>	<u>FY 10</u>	<u>FY 11</u>	<u>Future</u>
Development	0	0	0	0	0	0	0	0	0
Design	100	0	0	0	100	0	0	0	0
Land/ROW	0	0	0	0	0	0	0	0	0
Construction	750	0	0	0	750	0	0	0	0
Equipment	0	0	0	0	0	0	0	0	0
Administration	0	0	0	0	0	0	0	0	0
<b>Total</b>	<b>\$850</b>	<b>\$0</b>	<b>\$0</b>	<b>\$0</b>	<b>\$850</b>	<b>\$0</b>	<b>\$0</b>	<b>\$0</b>	<b>\$0</b>

**Funding Sources (in \$000's):**

	<u>Total Est Cost</u>	<u>Prior Yrs Funding</u>	<u>FY 06</u>	<u>FY 07</u>	<u>FY 08</u>	<u>FY 09</u>	<u>FY 10</u>	<u>FY 11</u>	<u>Future</u>
Ad Valorem	450	0	0	0	450	0	0	0	0
Gas Taxes	400	0	0	0	400	0	0	0	0
<b>Total</b>	<b>\$850</b>	<b>\$0</b>	<b>\$0</b>	<b>\$0</b>	<b>\$850</b>	<b>\$0</b>	<b>\$0</b>	<b>\$0</b>	<b>\$0</b>

**PROJECT TITLE:**  
**DURANT ROAD OVER BRANCH OF TURKEY CREEK BRIDGE**

**PROJECT NO:** 69217

**CIE REQUIREMENT:** Y

**LEVEL OF SERVICE IMPACT:** M

**PROGRAM:** TRANSPORTATION/BRIDGES

**Project Description:**

Completely replace bridge #104421 and realign approaches to improve safety.

**Neighborhood Community Area:**

East Hillsborough (Northeast)

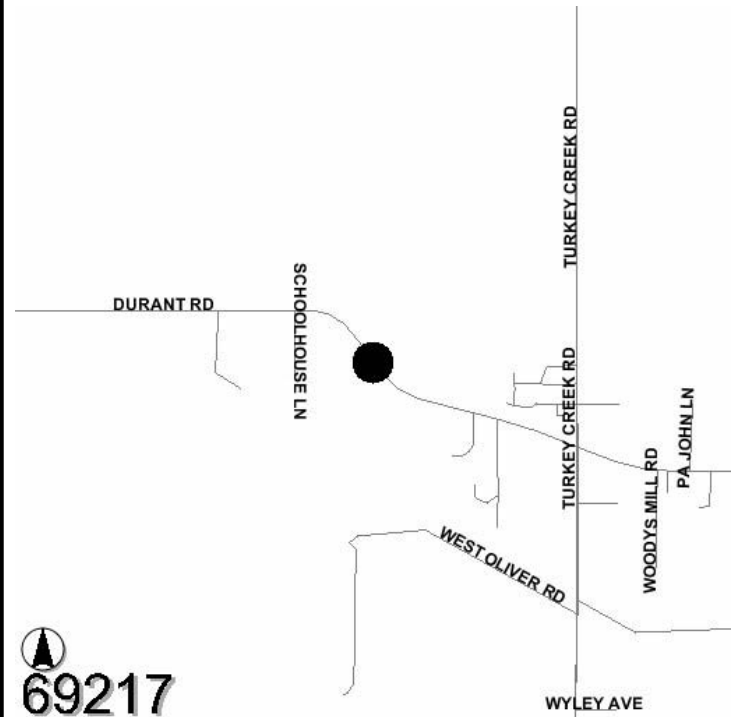

**Operating Cost Impact:**

Annual operating and maintenance costs are estimated to be \$1,400 per year.

**Project Completion Date:** Jul 2007

**Expenditure Plan (in \$000's):**

	<u>Total Est Cost</u>	<u>Prior Yrs Funding</u>	<u>FY 06</u>	<u>FY 07</u>	<u>FY 08</u>	<u>FY 09</u>	<u>FY 10</u>	<u>FY 11</u>	<u>Future</u>
Development	100	100	0	0	0	0	0	0	0
Design	219	219	0	0	0	0	0	0	0
Land/ROW	70	20	50	0	0	0	0	0	0
Construction	1,608	87	721	800	0	0	0	0	0
Equipment	0	0	0	0	0	0	0	0	0
Administration	10	0	10	0	0	0	0	0	0
<b>Total</b>	<b>\$2,007</b>	<b>\$426</b>	<b>\$781</b>	<b>\$800</b>	<b>\$0</b>	<b>\$0</b>	<b>\$0</b>	<b>\$0</b>	<b>\$0</b>

**Funding Sources (in \$000's):**

	<u>Total Est Cost</u>	<u>Prior Yrs Funding</u>	<u>FY 06</u>	<u>FY 07</u>	<u>FY 08</u>	<u>FY 09</u>	<u>FY 10</u>	<u>FY 11</u>	<u>Future</u>
Ad Valorem	1,501	0	701	800	0	0	0	0	0
Financing - CIT Backed	416	350	66	0	0	0	0	0	0
Impact Fees	90	76	14	0	0	0	0	0	0
<b>Total</b>	<b>\$2,007</b>	<b>\$426</b>	<b>\$781</b>	<b>\$800</b>	<b>\$0</b>	<b>\$0</b>	<b>\$0</b>	<b>\$0</b>	<b>\$0</b>





**PROJECT TITLE:**  
**FRIENDSHIP TRAIL BRIDGE REPAIRS - PHASE II**

**PROJECT NO:** 62232

**CIE REQUIREMENT:** Y

**LEVEL OF SERVICE IMPACT:** M

**PROGRAM:** TRANSPORTATION/BRIDGES

**Project Description:**

Implement additional repairs to the Friendship Trail Bridge substructure. Maintenance is required to keep the facility structurally safe and operational.

**Neighborhood Community Area:**

City of Tampa

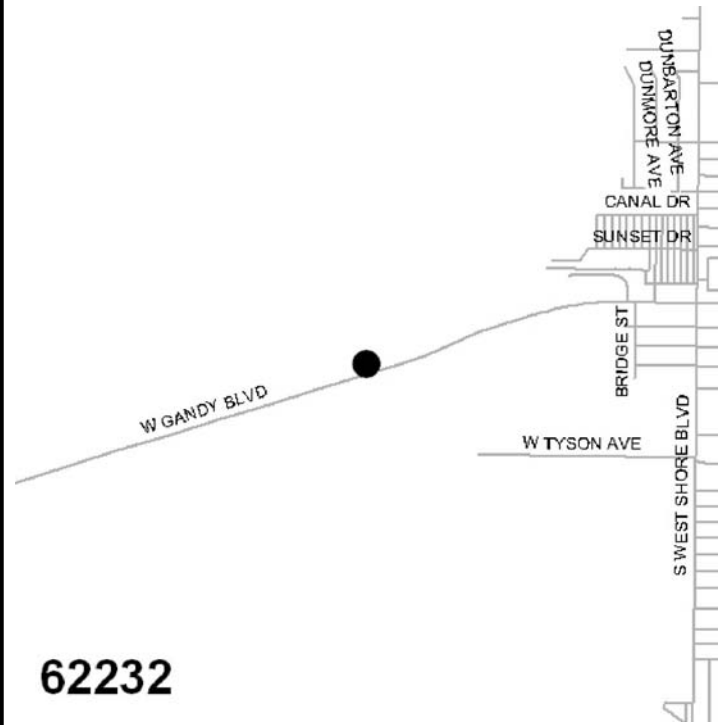

**Operating Cost Impact:**

No impact on annual operating and maintenance costs is anticipated.

**Project Completion Date:** May 2008

**Expenditure Plan (in \$000's):**

	<u>Total Est Cost</u>	<u>Prior Yrs Funding</u>	<u>FY 06</u>	<u>FY 07</u>	<u>FY 08</u>	<u>FY 09</u>	<u>FY 10</u>	<u>FY 11</u>	<u>Future</u>
Development	0	0	0	0	0	0	0	0	0
Design	0	0	0	0	0	0	0	0	0
Land/ROW	0	0	0	0	0	0	0	0	0
Construction	2,400	0	0	2,400	0	0	0	0	0
Equipment	0	0	0	0	0	0	0	0	0
Administration	0	0	0	0	0	0	0	0	0
<b>Total</b>	<b>\$2,400</b>	<b>\$0</b>	<b>\$0</b>	<b>\$2,400</b>	<b>\$0</b>	<b>\$0</b>	<b>\$0</b>	<b>\$0</b>	<b>\$0</b>

**Funding Sources (in \$000's):**

	<u>Total Est Cost</u>	<u>Prior Yrs Funding</u>	<u>FY 06</u>	<u>FY 07</u>	<u>FY 08</u>	<u>FY 09</u>	<u>FY 10</u>	<u>FY 11</u>	<u>Future</u>
Ad Valorem	2,400	0	0	2,400	0	0	0	0	0
<b>Total</b>	<b>\$2,400</b>	<b>\$0</b>	<b>\$0</b>	<b>\$2,400</b>	<b>\$0</b>	<b>\$0</b>	<b>\$0</b>	<b>\$0</b>	<b>\$0</b>