



**PROJECT TITLE:**  
**CARROLLWOOD/DALE MABRY RW PUMP STATION REPLACEMENT**

**PROJECT NO: 10782**

**CIE REQUIREMENT: Y**

**LEVEL OF SERVICE IMPACT: M**

**PROGRAM: WATER SERVICES/RECLAIMED WATER**

**Project Description:**

Design and construction of a new 9,000 gallon per minute reclaimed water pump station to be located at the existing Dale Mabry AWTP. This will replace the existing station. A new electrical control building, noise abatement, metering, telemetry, light shielding and other necessary appurtenances will be provided. The old pump station will be demolished when the new one is completed and in service.

**Neighborhood Community Area:**

Carrollwood (North Tampa)

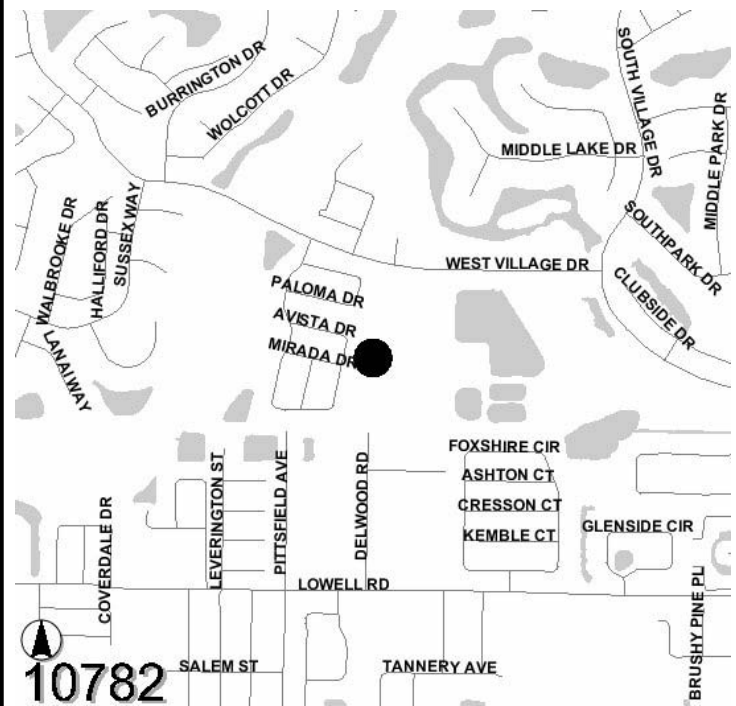

**Operating Cost Impact:**

Operating Cost Impact of \$10,000 starting in FY 09 and \$20,000 thereafter

**Project Completion Date: May 2009**

**Expenditure Plan (in \$000's):**

	<u>Total Est Cost</u>	<u>Prior Yrs Funding</u>	<u>FY 06</u>	<u>FY 07</u>	<u>FY 08</u>	<u>FY 09</u>	<u>FY 10</u>	<u>FY 11</u>	<u>Future</u>
Development	172	0	172	0	0	0	0	0	0
Design	903	0	903	0	0	0	0	0	0
Land/ROW	0	0	0	0	0	0	0	0	0
Construction	3,096	0	0	3,096	0	0	0	0	0
Equipment	0	0	0	0	0	0	0	0	0
Administration	129	0	129	0	0	0	0	0	0
<b>Total</b>	<b>\$4,300</b>	<b>\$0</b>	<b>\$1,204</b>	<b>\$3,096</b>	<b>\$0</b>	<b>\$0</b>	<b>\$0</b>	<b>\$0</b>	<b>\$0</b>

**Funding Sources (in \$000's):**

	<u>Total Est Cost</u>	<u>Prior Yrs Funding</u>	<u>FY 06</u>	<u>FY 07</u>	<u>FY 08</u>	<u>FY 09</u>	<u>FY 10</u>	<u>FY 11</u>	<u>Future</u>
Enterprise Fees	1,204	0	1,204	0	0	0	0	0	0
Financing	3,096	0	0	3,096	0	0	0	0	0
<b>Total</b>	<b>\$4,300</b>	<b>\$0</b>	<b>\$1,204</b>	<b>\$3,096</b>	<b>\$0</b>	<b>\$0</b>	<b>\$0</b>	<b>\$0</b>	<b>\$0</b>





