



**PROJECT TITLE:**  
TOWN N COUNTRY GREENWAY CONNECTION  
**CIE REQUIREMENT:** Y  
**LEVEL OF SERVICE IMPACT:** E

**PROJECT NO:** 80329

**PROGRAM:** PARKS

**Project Description:**

Install bike lanes on both sides of Sheldon Road from Town N' Country Greenway to Waters Ave. Install bike lanes on Woodlake Blvd. Install mid-block pedestrian crosswalk on Sheldon Road at Greenway to include pedestrian signal installation and median/curb modifications. Modify or install sidewalk as needed. This segment of roadway is close to major trail systems, YMCA and a proposed Hartline facility. The roadway is heavily traveled and providing bike lanes, crosswalk and sidewalk improvements will reduce safety concerns.

**Operating Cost Impact:**

Operating cost is estimated at \$6,000 starting in FY09.

**Project Completion Date:** May 2009

**Neighborhood Community Area:**

Town N' Country (Northwest)

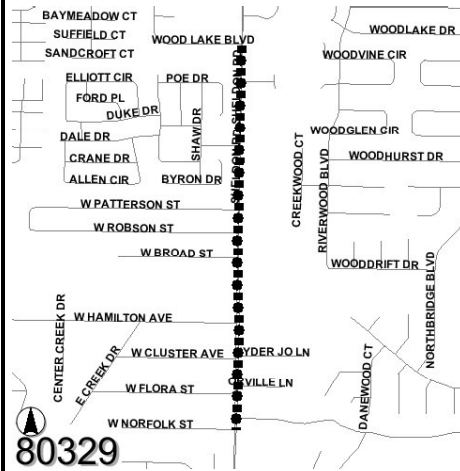

80329

**Expenditure Plan (in \$000's):**

	<u>Total Est Cost</u>	<u>Prior Yrs Funding</u>	<u>FY 07</u>	<u>FY 08</u>	<u>FY 09</u>	<u>FY 10</u>	<u>FY 11</u>	<u>Future</u>
Development	0	0	0	0	0	0	0	0
Design	100	100	0	0	0	0	0	0
Land/ROW	0	0	0	0	0	0	0	0
Construction	474	0	0	474	0	0	0	0
Equipment	0	0	0	0	0	0	0	0
Administration	0	0	0	0	0	0	0	0
<b>Total</b>	<b>\$574</b>	<b>\$100</b>	<b>\$0</b>	<b>\$474</b>	<b>\$0</b>	<b>\$0</b>	<b>\$0</b>	<b>\$0</b>

**Funding Sources (in \$000's):**

	<u>Total Est Cost</u>	<u>Prior Yrs Funding</u>	<u>FY 07</u>	<u>FY 08</u>	<u>FY 09</u>	<u>FY 10</u>	<u>FY 11</u>	<u>Future</u>
Community Invest. Tax III	574	100	0	474	0	0	0	0
<b>Total</b>	<b>\$574</b>	<b>\$100</b>	<b>\$0</b>	<b>\$474</b>	<b>\$0</b>	<b>\$0</b>	<b>\$0</b>	<b>\$0</b>

**PROJECT TITLE:**  
TOWN N' COUNTRY/SHIMBERG SOCCER FIELD EXPANSION (CIT II)  
**CIE REQUIREMENT:** Y  
**LEVEL OF SERVICE IMPACT:** F

**PROJECT NO:** 89314

**PROGRAM:** PARKS

**Project Description:**

Construct additional soccer fields at Shimberg Park in Town N' County.

**Operating Cost Impact:**

Operating cost is estimated to be \$135,667 in FY 09 and \$146,000 thereafter.

**Project Completion Date:** Oct 2008

**Neighborhood Community Area:**

Town N' Country (Northwest)

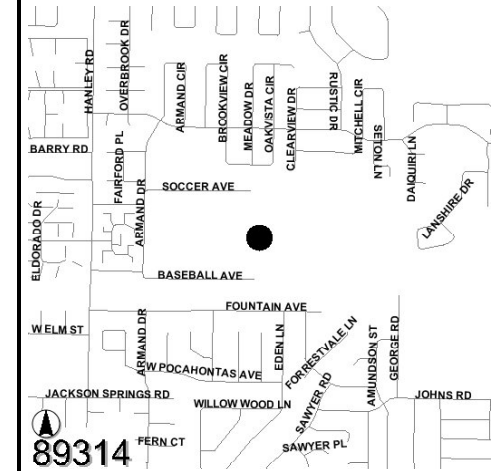

89314

**Expenditure Plan (in \$000's):**

	<u>Total Est Cost</u>	<u>Prior Yrs Funding</u>	<u>FY 07</u>	<u>FY 08</u>	<u>FY 09</u>	<u>FY 10</u>	<u>FY 11</u>	<u>Future</u>
Development	37	0	37	0	0	0	0	0
Design	0	0	0	0	0	0	0	0
Land/ROW	0	0	0	0	0	0	0	0
Construction	685	0	155	530	0	0	0	0
Equipment	0	0	0	0	0	0	0	0
Administration	28	0	8	20	0	0	0	0
<b>Total</b>	<b>\$750</b>	<b>\$0</b>	<b>\$200</b>	<b>\$550</b>	<b>\$0</b>	<b>\$0</b>	<b>\$0</b>	<b>\$0</b>

**Funding Sources (in \$000's):**

	<u>Total Est Cost</u>	<u>Prior Yrs Funding</u>	<u>FY 07</u>	<u>FY 08</u>	<u>FY 09</u>	<u>FY 10</u>	<u>FY 11</u>	<u>Future</u>
Community Invest. Tax II	750	0	200	550	0	0	0	0
<b>Total</b>	<b>\$750</b>	<b>\$0</b>	<b>\$200</b>	<b>\$550</b>	<b>\$0</b>	<b>\$0</b>	<b>\$0</b>	<b>\$0</b>





