

PROJECT TITLE: RECLAIMED WATER PUMP STATION R&R - FARE ACCOUNT PROJECT NO: 19657  
 CIE REQUIREMENT: Y  
 LEVEL OF SERVICE IMPACT: M PROGRAM: WATER SERVICES/RECLAIMED WATER

**Project Description:**  
 Provides funding for the estimated amount of reclaimed water pump station repairs and replacements due to the aging of the system. Individual projects and schedules will be identified the 1st two years of each CIP.

**Neighborhood Community Area:**  
 Countywide



**Operating Cost Impact:**  
 No significant change in operating costs is anticipated.

**Project Completion Date:** N/A

Expenditure Plan (in \$000's):									
	Total Est Cost	Prior Yrs Funding	FY 08	FY 09	FY 10	FY 11	FY 12	FY 13	Future
Development	52	0	0	0	26	26	0	0	0
Design	96	0	0	0	48	48	0	0	0
Land/ROW	0	0	0	0	0	0	0	0	0
Construction	518	0	0	0	259	259	0	0	0
Equipment	0	0	0	0	0	0	0	0	0
Administration	74	0	0	0	37	37	0	0	0
<b>Total</b>	<b>\$740</b>	<b>\$0</b>	<b>\$0</b>	<b>\$0</b>	<b>\$370</b>	<b>\$370</b>	<b>\$0</b>	<b>\$0</b>	<b>\$0</b>

Funding Sources (in \$000's):									
	Total Est Cost	Prior Yrs Funding	FY 08	FY 09	FY 10	FY 11	FY 12	FY 13	Future
Enterprise Fees	740	0	0	0	370	370	0	0	0
<b>Total</b>	<b>\$740</b>	<b>\$0</b>	<b>\$0</b>	<b>\$0</b>	<b>\$370</b>	<b>\$370</b>	<b>\$0</b>	<b>\$0</b>	<b>\$0</b>

PROJECT TITLE: RECLAIMED WATER PUMP STATION REFURBISHMENT MASTER PROJECT PROJECT NO: 10795  
 CIE REQUIREMENT: Y  
 LEVEL OF SERVICE IMPACT: M PROGRAM: WATER SERVICES/RECLAIMED WATER

**Project Description:**  
 Repair/replace outdated equipment that fails at reclaimed water pumping stations such as pumps and control panels.

**Neighborhood Community Area:**  
 Countywide



**Operating Cost Impact:**  
 None

**Project Completion Date:** N/A

Expenditure Plan (in \$000's):										
	Total Est Cost	Prior Yrs Funding	FY 08	FY 09	FY 10	FY 11	FY 12	FY 13	Future	
Development	0	0	0	0	0	0	0	0	0	
Design	0	0	0	0	0	0	0	0	0	
Land/ROW	0	0	0	0	0	0	0	0	0	
Construction	795	315	80	80	80	80	80	80	0	
Equipment	40	40	0	0	0	0	0	0	0	
Administration	165	45	20	20	20	20	20	20	0	
<b>Total</b>	<b>\$1,000</b>	<b>\$400</b>	<b>\$100</b>	<b>\$100</b>	<b>\$100</b>	<b>\$100</b>	<b>\$100</b>	<b>\$100</b>	<b>\$0</b>	

Funding Sources (in \$000's):										
	Total Est Cost	Prior Yrs Funding	FY 08	FY 09	FY 10	FY 11	FY 12	FY 13	Future	
Enterprise Fees	1,000	400	100	100	100	100	100	100	0	
<b>Total</b>	<b>\$1,000</b>	<b>\$400</b>	<b>\$100</b>	<b>\$100</b>	<b>\$100</b>	<b>\$100</b>	<b>\$100</b>	<b>\$100</b>	<b>\$0</b>	

PROJECT TITLE: RWTM EXT. TO NEW DEVELOPMENTS AND RWIU'S-MASTER PROJECT PROJECT NO: 19017  
 CIE REQUIREMENT: Y LEVEL OF SERVICE IMPACT: E,F PROGRAM: WATER SERVICES/RECLAIMED WATER

**Project Description:**  
 Design and construction of RWTM's to new developments and existing RWIU's.

**Neighborhood Community Area:**  
 Countywide



**Operating Cost Impact:**  
 Operating cost impact of \$1,200 per year starting in FY 07.

**Project Completion Date:** N/A

Expenditure Plan (in \$000's):									
	Total Est Cost	Prior Yrs Funding	FY 08	FY 09	FY 10	FY 11	FY 12	FY 13	Future
Development	12	3	0	3	3	3	0	0	0
Design	128	113	0	5	5	5	0	0	0
Land/ROW	30	30	0	0	0	0	0	0	0
Construction	1,491	984	0	169	169	169	0	0	0
Equipment	0	0	0	0	0	0	0	0	0
Administration	239	170	0	23	23	23	0	0	0
<b>Total</b>	<b>\$1,900</b>	<b>\$1,300</b>	<b>\$0</b>	<b>\$200</b>	<b>\$200</b>	<b>\$200</b>	<b>\$0</b>	<b>\$0</b>	<b>\$0</b>

Funding Sources (in \$000's):									
	Total Est Cost	Prior Yrs Funding	FY 08	FY 09	FY 10	FY 11	FY 12	FY 13	Future
Enterprise Fees	1,900	1,300	0	200	200	200	0	0	0
<b>Total</b>	<b>\$1,900</b>	<b>\$1,300</b>	<b>\$0</b>	<b>\$200</b>	<b>\$200</b>	<b>\$200</b>	<b>\$0</b>	<b>\$0</b>	<b>\$0</b>

PROJECT TITLE: SYDNEY/DOVER RECLAIMED WATER RESERVOIR PROJECT NO: 10644  
 CIE REQUIREMENT: Y LEVEL OF SERVICE IMPACT: F PROGRAM: WATER SERVICES/RECLAIMED WATER

**Project Description:**  
 Growth in the south central part of the County requires additional treatment capacity at this facility. This project will design and construct an approximately 1 billion gallon reclaimed water storage reservoir using the old Sydney mine site near the existing Valrico AWTP.

**Neighborhood Community Area:**  
 Valrico (Central)

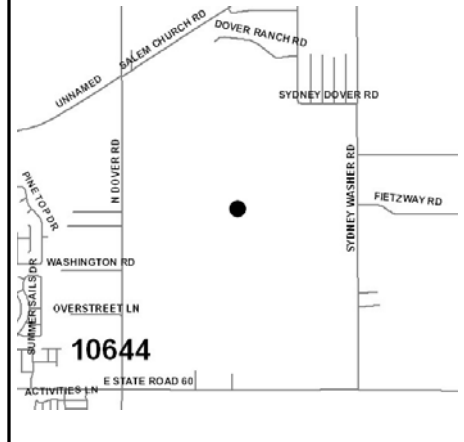

**Operating Cost Impact:**  
 None

**Project Completion Date:** Aug 2016

Expenditure Plan (in \$000's):										
	Total Est Cost	Prior Yrs Funding	FY 08	FY 09	FY 10	FY 11	FY 12	FY 13	Future	
Development	350	0	0	0	0	350	0	0	0	
Design	6,800	0	0	0	0	6,800	0	0	0	
Land/ROW	0	0	0	0	0	0	0	0	0	
Construction	27,900	0	0	0	0	0	27,900	0	0	
Equipment	0	0	0	0	0	0	0	0	0	
Administration	200	0	0	0	0	100	100	0	0	
<b>Total</b>	<b>\$35,250</b>	<b>\$0</b>	<b>\$0</b>	<b>\$0</b>	<b>\$0</b>	<b>\$7,250</b>	<b>\$28,000</b>	<b>\$0</b>	<b>\$0</b>	

Funding Sources (in \$000's):										
	Total Est Cost	Prior Yrs Funding	FY 08	FY 09	FY 10	FY 11	FY 12	FY 13	Future	
Enterprise Fees	35,250	0	0	0	0	7,250	28,000	0	0	
<b>Total</b>	<b>\$35,250</b>	<b>\$0</b>	<b>\$0</b>	<b>\$0</b>	<b>\$0</b>	<b>\$7,250</b>	<b>\$28,000</b>	<b>\$0</b>	<b>\$0</b>	

PROJECT TITLE: VALRICO RECLAIMED WATER PUMP STATION REPLACEMENT PROJECT NO: 10783  
 CIE REQUIREMENT: Y  
 LEVEL OF SERVICE IMPACT: E PROGRAM: WATER SERVICES/RECLAIMED WATER

**Project Description:**  
 Design and construct a new 12,000 GPM reclaimed water pumping station at the Valrico WWTP to include a new electrical building, electrical service, piping, controls, backfill capability into the existing RW storage tanks from the distribution system. Additionally, Diamond Hills will be disconnected from the sprayfield line and connected directly into the reclaimed water distribution system.

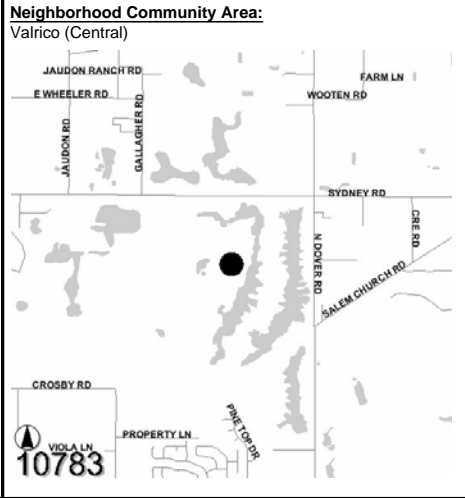

**Operating Cost Impact:**  
 Operating cost impact of \$24,000 in FY 07 and \$32,000 thereafter.

**Project Completion Date:** Dec 2007

**Expenditure Plan (in \$000's):**

	<u>Total Est Cost</u>	<u>Prior Yrs Funding</u>	<u>FY 08</u>	<u>FY 09</u>	<u>FY 10</u>	<u>FY 11</u>	<u>FY 12</u>	<u>FY 13</u>	<u>Future</u>
Development	0	0	0	0	0	0	0	0	0
Design	1,037	1,037	0	0	0	0	0	0	0
Land/ROW	0	0	0	0	0	0	0	0	0
Construction	3,874	3,874	0	0	0	0	0	0	0
Equipment	0	0	0	0	0	0	0	0	0
Administration	189	189	0	0	0	0	0	0	0
<b>Total</b>	<b>\$5,100</b>	<b>\$5,100</b>	<b>\$0</b>	<b>\$0</b>	<b>\$0</b>	<b>\$0</b>	<b>\$0</b>	<b>\$0</b>	<b>\$0</b>

**Funding Sources (in \$000's):**

	<u>Total Est Cost</u>	<u>Prior Yrs Funding</u>	<u>FY 08</u>	<u>FY 09</u>	<u>FY 10</u>	<u>FY 11</u>	<u>FY 12</u>	<u>FY 13</u>	<u>Future</u>
Capacity Fees	474	474	0	0	0	0	0	0	0
Enterprise Fees	4,626	4,626	0	0	0	0	0	0	0
<b>Total</b>	<b>\$5,100</b>	<b>\$5,100</b>	<b>\$0</b>	<b>\$0</b>	<b>\$0</b>	<b>\$0</b>	<b>\$0</b>	<b>\$0</b>	<b>\$0</b>